



Mapping reproduced by permission of Ordnance Survey on behalf of HMSO. © Crown Copyright and Database right 2012. All rights reserved. Ordnance Survey licence number 100019345

Keyplan:  
This drawing

Coordinates are to be Ordnance Survey Datum OSGB36. All levels are in metres and relate to the Tunnel Datum which is 100 metres below Ordnance Datum Newlyn.

**Key:**

- Limits of land to be acquired or used (LLAU)
- Existing public right of way
- Route of temporary diversion of right of way
- Existing right of way temporarily stopped up
- Area of highway to be temporarily stopped up
- Area of temporary suspension of public rights of navigation
- Ap Access to permanent works
- Ac Access to construction works

**Notes:**

- This plan does not show stopping up and diversions of limited duration (eg hoarding erection, minor utility diversions and minor highway works).
- Only rights of way in or close to worksites are shown. The full extents of rights of way are not shown where they cease to be relevant to the project.

We, Lindsay Speed and Sarah Fairbrother, are authorised by the Secretaries of State for Communities and Local Government and Environment, Food and Rural Affairs, to hereby certify that this plan is a true copy of a plan referred to in Article 61 (1) (b) and schedule 2 part 3 of the Thames Water Utilities Limited (Thames Tideway Tunnel) Order 2014.

*Lindsay Speed* *Sarah Fairbrother*

24 September 2014

10m 0 40m  
Scale 1:500 at A1  
1:1000 if reproduced at A3

**FOR APPROVAL**

Location  
**Cremorne Wharf Depot**  
Royal Borough of Kensington & Chelsea

Document Information  
**Application for Development Consent**  
Access plan

Book of plans - section 13  
DCO-PP-11X-CREWD-130003  
January 2013

Thames Tideway Tunnel  
Creating a cleaner, healthier River Thames

Thames Water



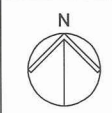

Mapping reproduced by permission of Ordnance Survey on behalf of HMSO. © Crown Copyright and Database right 2014. All rights reserved. Ordnance Survey licence number 100019345



Coordinates are to be Ordnance Survey Datum OSGB36. All levels are in metres and relate to the Tunnel Datum which is 100 metres below Ordnance Datum Newlyn.

We, Lindsay Speed and Sarah Fairbrother, are authorised by the Secretaries of State for Communities and Local Government and Environment, Food and Rural Affairs, to hereby certify that this plan is a true copy of a plan referred to in Article 61 (1) (d) and schedule 2 part 4 of the Thames Water Utilities Limited (Thames Tideway Tunnel) Order 2014.

*Lindsay Speed* *Sarah Fairbrother*

24 September 2014

- Key:**
- Limits of land to be acquired or used (LLAU)
  - [Cross-hatched box] Trees to be removed
  - [Orange box] Above ground structures to be removed
  - [Purple box] Below ground structures to be removed or infilled
  - [Green box] Structure to be removed and relocated or reinstated

- Notes:**
- Minor items to be removed (e.g. barriers, bollards etc.) are not shown.
  - General activities of site clearance such as removal of hardstanding and foundations, stripping of topsoil and clearance of minor vegetation not shown.

- Rev 1:**
- Location of existing ventilation column corrected.

- Rev 2:**
- Redundant services and brick chamber corrected.

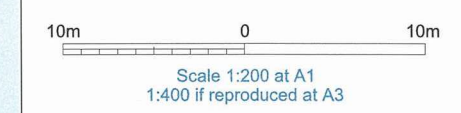

**FOR APPROVAL**

**Location**  
**Cremorne Wharf Depot**  
Royal Borough of Kensington & Chelsea

**Document Information**  
**Application for Development Consent**  
Demolition and site clearance

Book of plans - section 13  
DCO-PP-11X-CREWD-130004 - Rev 2  
March 2014

Creating a cleaner, healthier River Thames



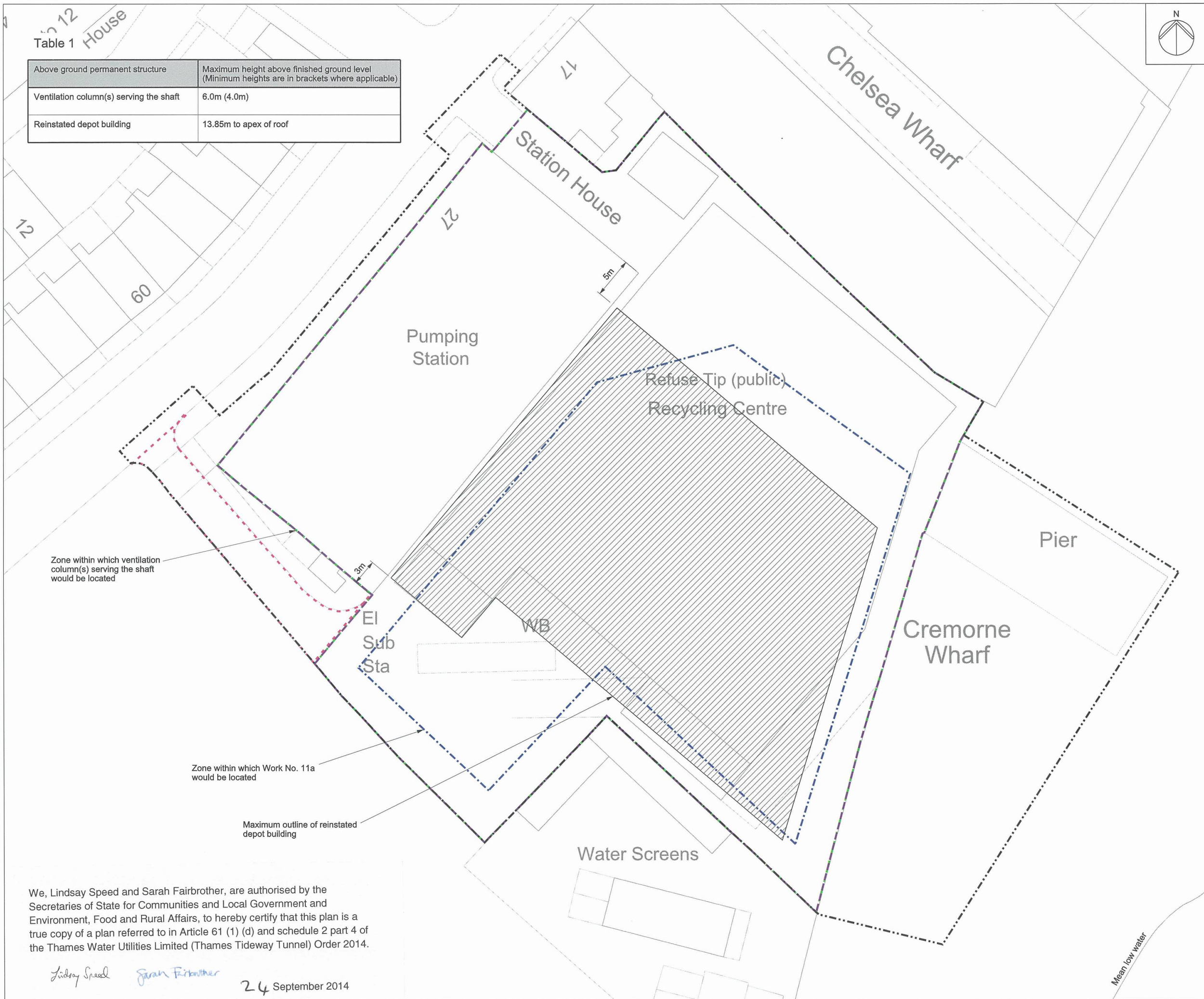

Mapping reproduced by permission of Ordnance Survey on behalf of HMSO. © Crown Copyright and Database right 2014. All rights reserved. Ordnance Survey licence number 100019345

Keyplan:

This drawing

Coordinates are to be Ordnance Survey Datum OSGB36. All levels are in metres and relate to the Tunnel Datum which is 100 metres below Ordnance Datum Newlyn.

Key:

- Limits of land to be acquired or used (LLAU)
- Zone within which all permanent site structures would be located
- Zone within which the shaft would be located
- Zone within which permanent above ground structures would be located (those listed in Table 1)
- Limits of permanent access
- Reinstated depot building

Notes:

- All dimensions and levels are approximate.
- The Site Works Parameter Key Plan identifies each zone independently.
- The zone within which the shaft would be located would include all permanent works including shaft walls (including appropriate allowances for construction tolerances) and if applicable under-reaming. Shaft construction temporary works may be located within or outside this zone provided they are located within the Limits of land to be acquired or used.

Rev 1:

- Maximum height of ventilation column(s) serving the shaft reduced in table 1.

10m 0 10m

Scale 1:200 at A1  
1:400 if reproduced at A3

**FOR APPROVAL**

Location  
**Cremorne Wharf Depot**  
Royal Borough of Kensington & Chelsea

Document Information  
**Application for Development Consent**  
Site works parameter plan

Book of plans - section 13  
DCO-PP-11X-CREWD-130005 - Rev 1  
March 2014

Thames Tideway Tunnel  
Creating a cleaner, healthier River Thames

Thames Water

© Thames Water Utilities Ltd 2014



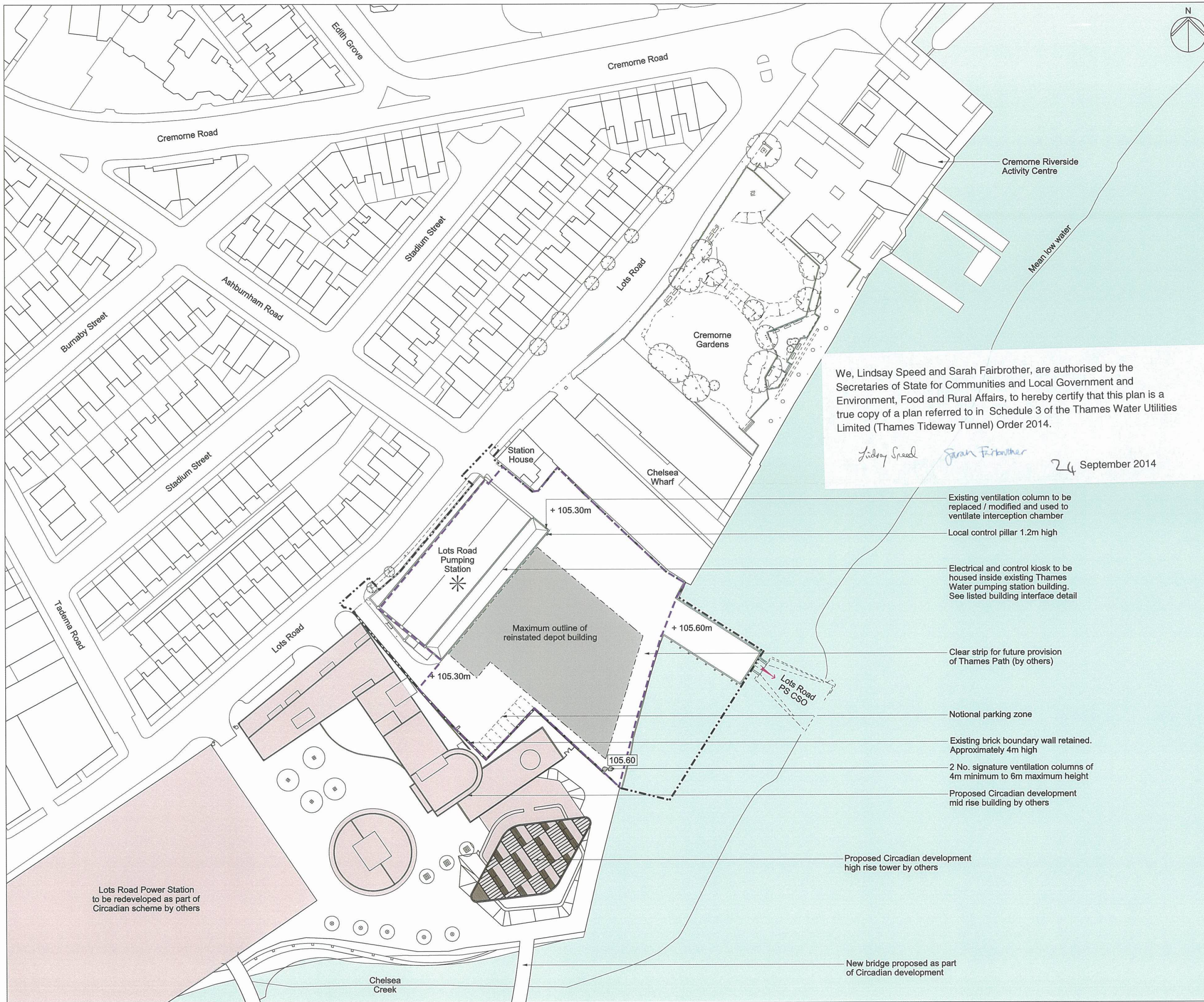

Mapping reproduced by permission of Ordnance Survey on behalf of HMSO. © Crown Copyright and Database right 2014. All rights reserved. Ordnance Survey licence number 100019345



Coordinates are to be Ordnance Survey Datum OSGB36. All levels are in metres and relate to the Tunnel Datum which is 100 metres below Ordnance Datum Newlyn.

- Key:**
- Limits of land to be acquired or used (LLAU)
  - - - Zone within which permanent above ground structures would be located
  - + 105.40m Existing levels (shown in metres above tunnel datum)
  - 105.40 Proposed levels (shown in metres above tunnel datum)
  - Consented development footprint (by others)
  - Listed buildings/structures
  - Approximate position of CSO outlet
  - Existing trees within surveyed area (trunk sizes vary)

- Notes:**
- All dimensions and levels are approximate.
  - Any discrepancy between the location of structures and the parameters marked on the drawings are due to differences between the Ordnance Survey base and the topographic survey base, both of which have been used in the preparation of this drawing.
  - The above ground structures in the "Save for the scale of above ground structures which is indicative" statement are those listed in table 1 on the Site works parameter plan.
  - Access covers not shown on this drawing. Refer to the Permanent works layout for an indication of the extent of access covers required.

**Rev 1:**

- Maximum height of signature ventilation column(s) reduced.

10m 0 40m  
Scale 1:500 at A1  
1:1000 if reproduced at A3

**ILLUSTRATIVE**  
Save for the scale of above ground structures which is indicative

**Location**  
**Cremorne Wharf Depot**  
Royal Borough of Kensington & Chelsea

**Document Information**  
**Application for Development Consent**  
Proposed  
Site features plan  
Book of plans - section 13  
DCO-PP-11X-CREWD-130008 - Rev 1  
March 2014



We, Lindsay Speed and Sarah Fairbrother, are authorised by the Secretaries of State for Communities and Local Government and Environment, Food and Rural Affairs, to hereby certify that this plan is a true copy of a plan referred to in Schedule 3 of the Thames Water Utilities Limited (Thames Tideway Tunnel) Order 2014.

*Lindsay Speed* *Sarah Fairbrother* 24 September 2014

Existing ventilation column to be replaced / modified and used to ventilate interception chamber  
Local control pillar 1.2m high

Electrical and control kiosk to be housed inside existing Thames Water pumping station building. See listed building interface detail

Clear strip for future provision of Thames Path (by others)

Notional parking zone

Existing brick boundary wall retained. Approximately 4m high  
2 No. signature ventilation columns of 4m minimum to 6m maximum height

Proposed Circadian development mid rise building by others

Proposed Circadian development high rise tower by others

New bridge proposed as part of Circadian development

Lots Road Power Station to be redeveloped as part of Circadian scheme by others



Keyplan:



Coordinates are to be Ordnance Survey Datum OSGB36. All levels are in metres and relate to the Tunnel Datum which is 100 metres below Ordnance Datum Newlyn.

Key:

Maximum permanent extent of loss of listed buildings / structures

Notes:

1. All dimensions and levels are approximate.
2. Drawing is based on as-constructed drawings and topographical survey and not on heritage survey.

Rev 1:

1. Existing ventilation column corrected.

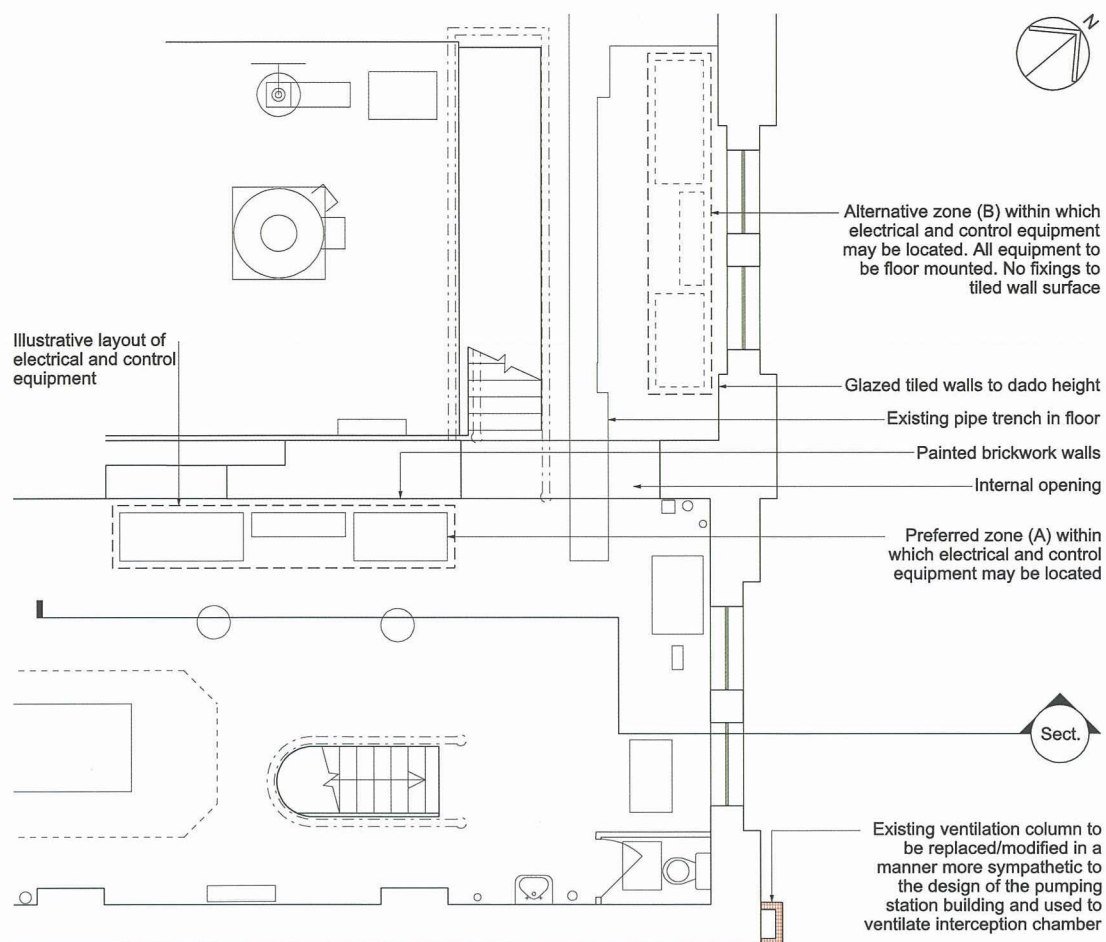

Intervention into pumping station (ground floor plan)

Scale 1:50

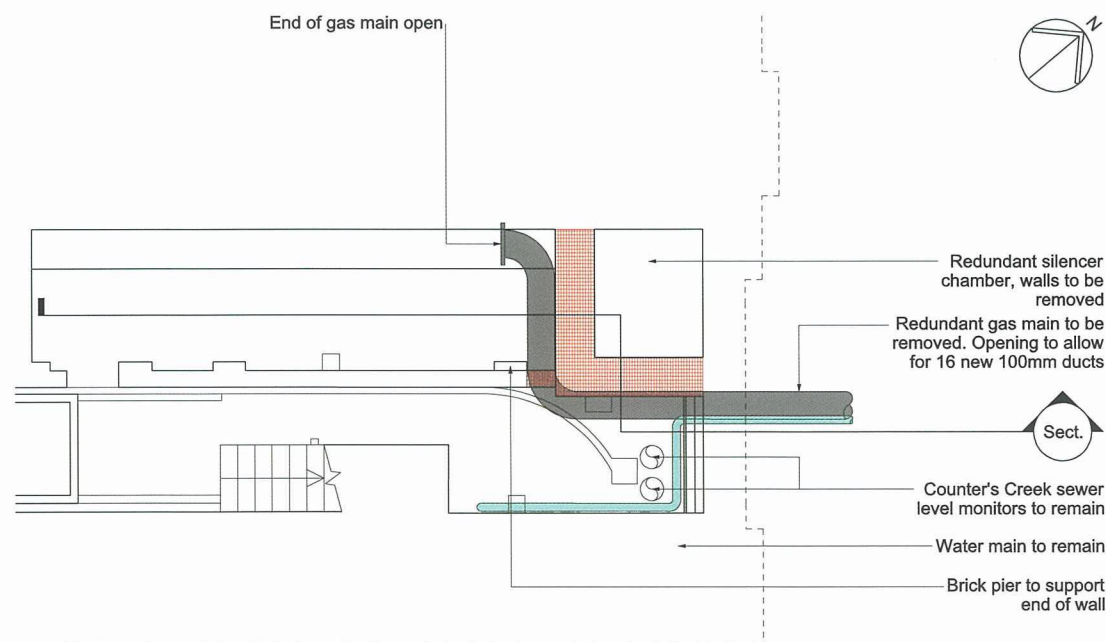

Intervention into pumping station (basement plan)

Scale 1:50

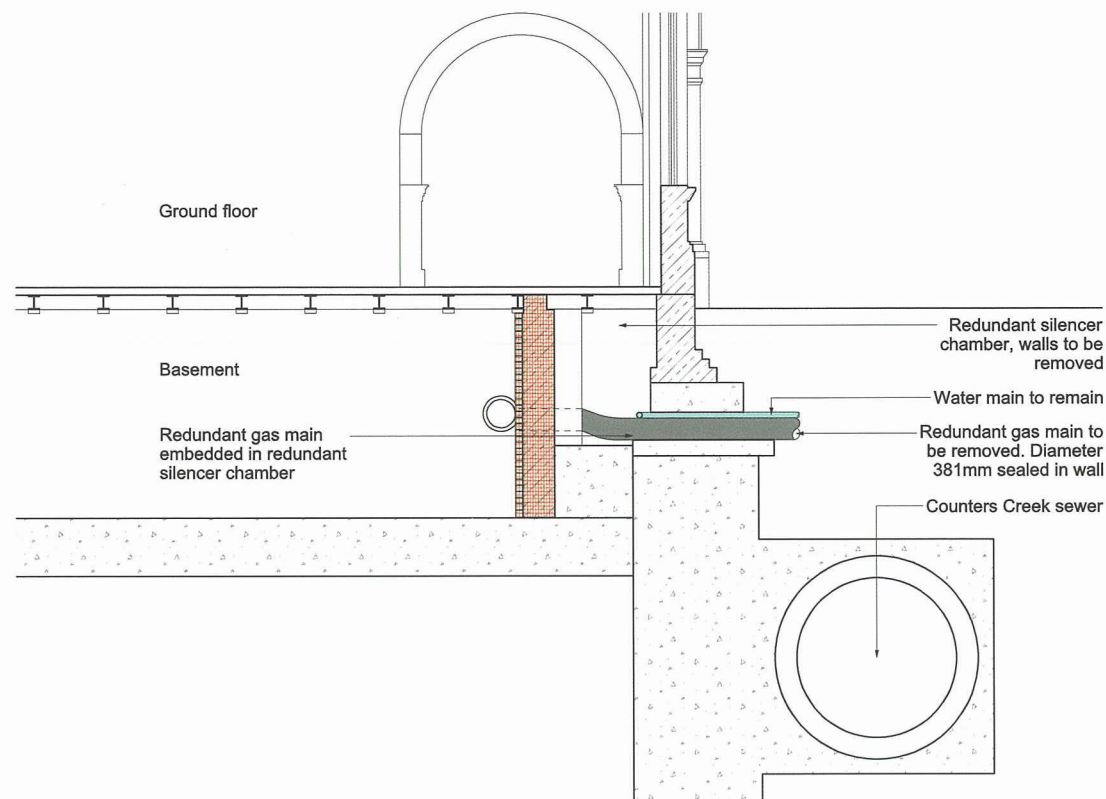

As existing detail section

Scale 1:50

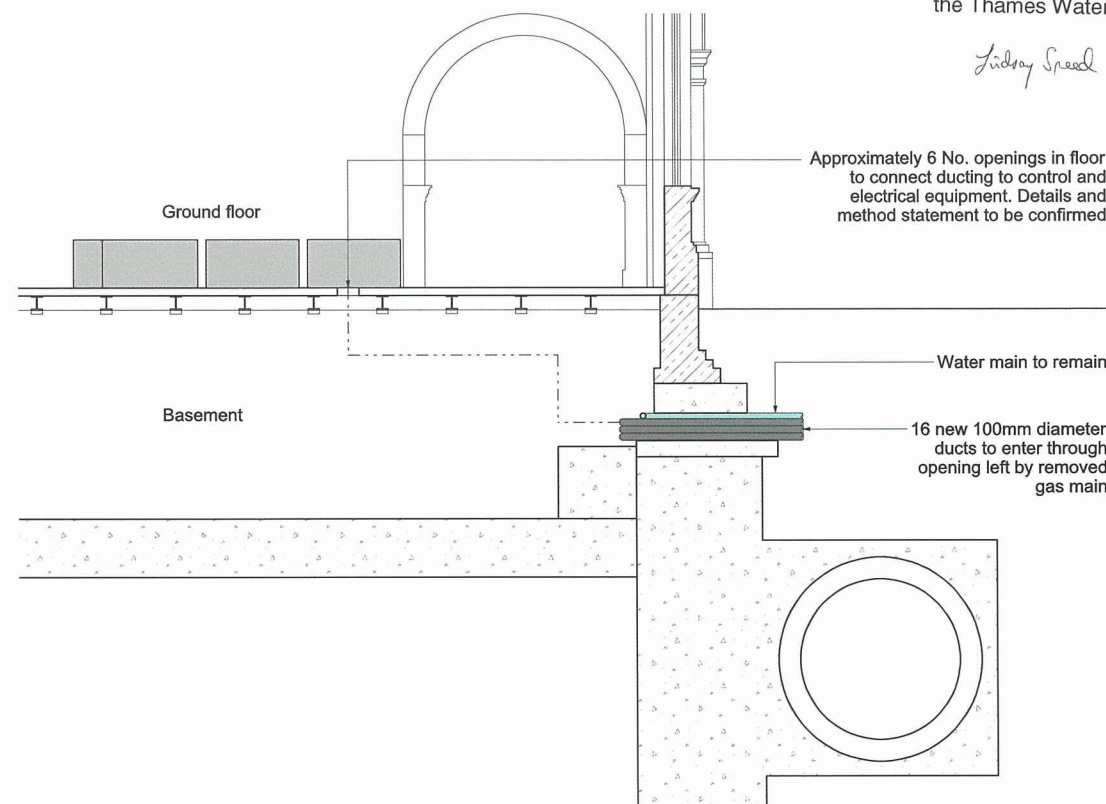

Proposed detail section

Scale 1:50

We, Lindsay Speed and Sarah Fairbrother, are authorised by the Secretaries of State for Communities and Local Government and Environment, Food and Rural Affairs, to hereby certify that this plan is a true copy of a plan referred to in Article 61 (1) (d) and schedule 2 part 4 of the Thames Water Utilities Limited (Thames Tideway Tunnel) Order 2014.

Lindsay Speed Sarah Fairbrother

24 September 2014

1m 0 4m

Scale 1:50 at A1  
1:100 if reproduced at A3

FOR APPROVAL

Location

**Cremorne Wharf Depot**  
Royal Borough of Kensington & Chelsea

Document Information

**Application for Development Consent**

Listed structure interface -  
Lots road pumping station  
Book of plans - section 13

DCO-PP-11X-CREWD-130012 - Rev 1  
January 2014

Thames  
Tideway Tunnel  
Creating a cleaner, healthier River Thames

