

Mapping reproduced by permission of Ordnance Survey on behalf of HMSO. © Crown Copyright and Database right 2013. All rights reserved. Ordnance Survey licence number 100019345



Coordinates are to be Ordnance Survey Datum OSGB36. All levels are in metres and relate to the Tunnel Datum which is 100 metres below Ordnance Datum Newlyn.

- Key:**
- Limits of land to be acquired or used (LLAU)
 - Existing public right of way
 - Route of temporary diversion of right of way
 - Existing right of way temporarily stopped up
 - Area of highway to be temporarily stopped up
 - Area of temporary suspension of public rights of navigation
 - Maximum area of permanent extinguishment of public rights of navigation
 - Ap ● Access to permanent works
 - Ac ● Access to construction works

- Notes:**
- This plan does not show stopping up and diversions of limited duration (eg hoarding erection, minor utility diversions and minor highway works).
 - Only rights of way in or close to worksites are shown. The full extents of rights of way are not shown where they cease to be relevant to the project.

- Rev 1:**
- Area of permanent extinguishment of public rights of navigation changed to a maximum area.

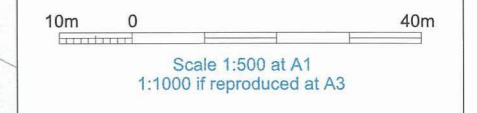

FOR APPROVAL

Location
Putney Embankment Foreshore
 London Borough of Wandsworth

Document Information
Application for Development Consent
 Access plan

Book of plans - section 8
 DCO-PP-05X-PUTEF-080003 - Rev 1
 September 2013

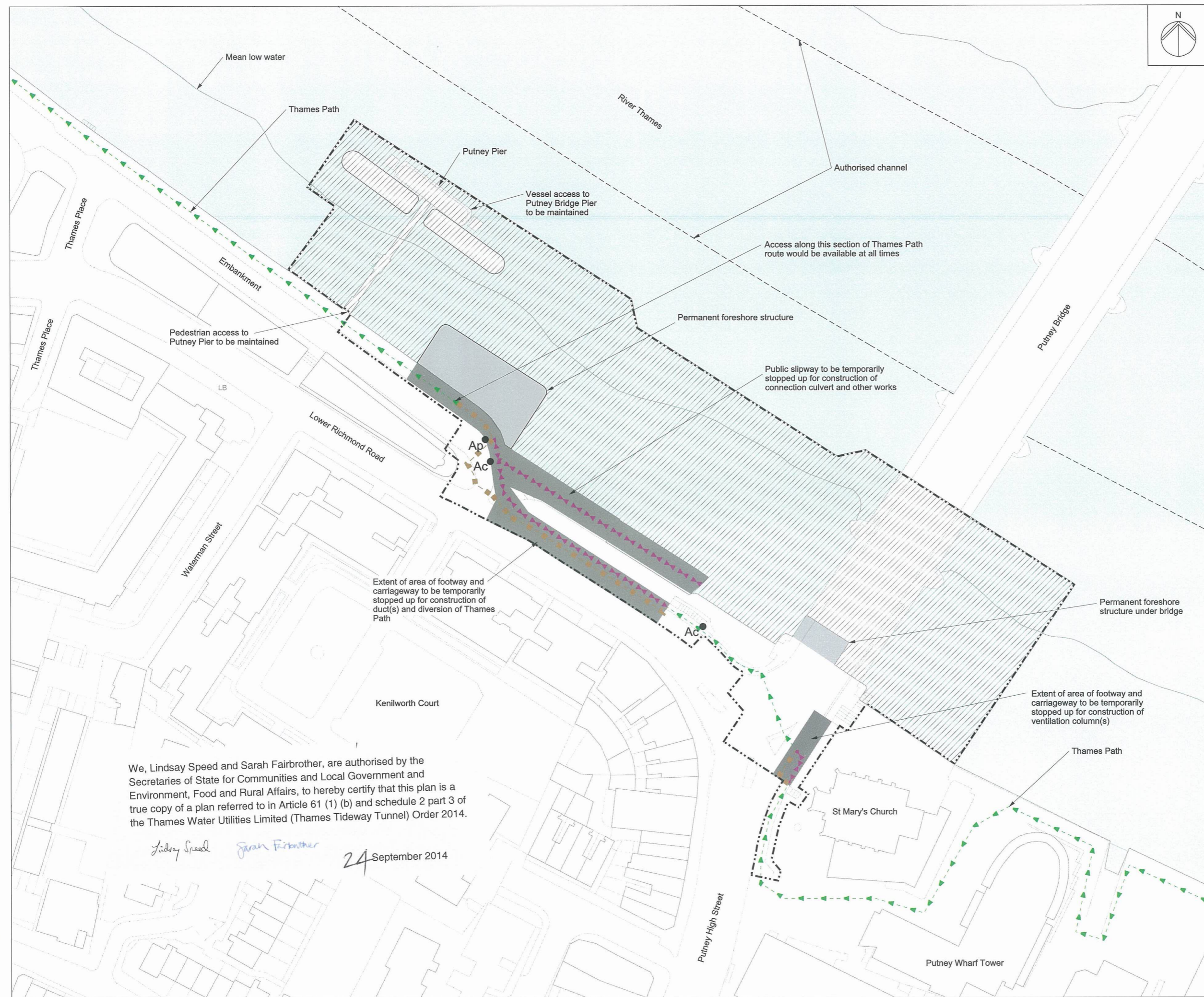

We, Lindsay Speed and Sarah Fairbrother, are authorised by the Secretaries of State for Communities and Local Government and Environment, Food and Rural Affairs, to hereby certify that this plan is a true copy of a plan referred to in Article 61 (1) (b) and schedule 2 part 3 of the Thames Water Utilities Limited (Thames Tideway Tunnel) Order 2014.

Lindsay Speed *Sarah Fairbrother*
 24 September 2014

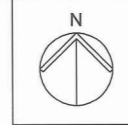

Mapping reproduced by permission of Ordnance Survey on behalf of HMSO. © Crown Copyright and Database right 2012. All rights reserved. Ordnance Survey licence number 100019345



Coordinates are to be Ordnance Survey Datum OSGB36. All levels are in metres and relate to the Tunnel Datum which is 100 metres below Ordnance Datum Newlyn.

- Key:**
- Limits of land to be acquired or used (LLAU)
 - - - Existing public right of way
 - - - Route of temporary diversion of right of way
 - ▲▲▲ Existing right of way temporarily stopped up
 - Area of highway to be temporarily stopped up
 - ▨ Area of temporary suspension of public rights of navigation
 - Ac ● Access to construction works
 - At ● Access to temporary slipway

- Notes:**
1. This plan does not show stopping up and diversions of limited duration (eg hoarding erection, minor utility diversions and minor highway works).
 2. Only rights of way in or close to worksites are shown. The full extents of rights of way are not shown where they cease to be relevant to the project.



FOR APPROVAL

Location
Putney Embankment Foreshore
London Borough of Wandsworth

Document Information
Application for Development Consent
Access plan
Temporary slipway
Book of plans - section 8
DCO-PP-05X-PUTEF-080004
January 2013



We, Lindsay Speed and Sarah Fairbrother, are authorised by the Secretaries of State for Communities and Local Government and Environment, Food and Rural Affairs, to hereby certify that this plan is a true copy of a plan referred to in Article 61 (1) (b) and schedule 2 part 3 of the Thames Water Utilities Limited (Thames Tideway Tunnel) Order 2014.

Lindsay Speed *Sarah Fairbrother*
24 September 2014

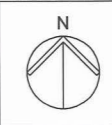

Mapping reproduced by permission of Ordnance Survey on behalf of HMSO. © Crown Copyright and Database right 2012. All rights reserved. Ordnance Survey licence number 100019345

We, Lindsay Speed and Sarah Fairbrother, are authorised by the Secretaries of State for Communities and Local Government and Environment, Food and Rural Affairs, to hereby certify that this plan is a true copy of a plan referred to in Article 61 (1) (d) and schedule 2 part 4 of the Thames Water Utilities Limited (Thames Tideway Tunnel) Order 2014.

Lindsay Speed *Sarah Fairbrother* 24 September 2014



Coordinates are to be Ordnance Survey Datum OSGB36. All levels are in metres and relate to the Tunnel Datum which is 100 metres below Ordnance Datum Newlyn.

- Key:**
- Limits of land to be acquired or used (LLAU)
 - Trees to be pruned
 - Structure to be removed and relocated or reinstated
 - Below ground structures to be removed or infilled

- Notes:**
1. Area of foreshore will require dredging prior to formation of temporary working area.
 2. Formation of temporary working area not illustrated, refer to construction phasing layout layout drawings.
 3. Minor items to be removed (e.g. barriers, bollards etc.) are not shown.
 4. General activities of site clearance such as removal of hardstanding and foundations, stripping of topsoil and clearance of minor vegetation not shown.

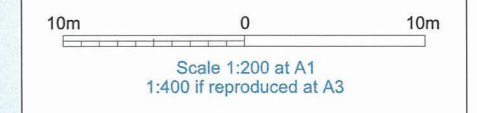
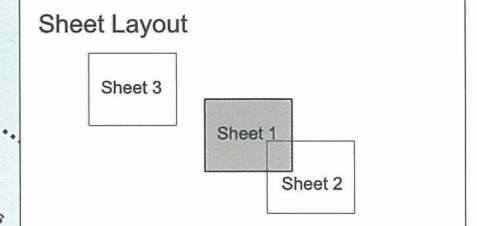

FOR APPROVAL

Location
Putney Embankment Foreshore
 London Borough of Wandsworth

Document Information
Application for Development Consent
 Demolition and site clearance
 Sheet 1 of 3
 Book of plans - section 8
 DCO-PP-05X-PUTEF-080005
 January 2013

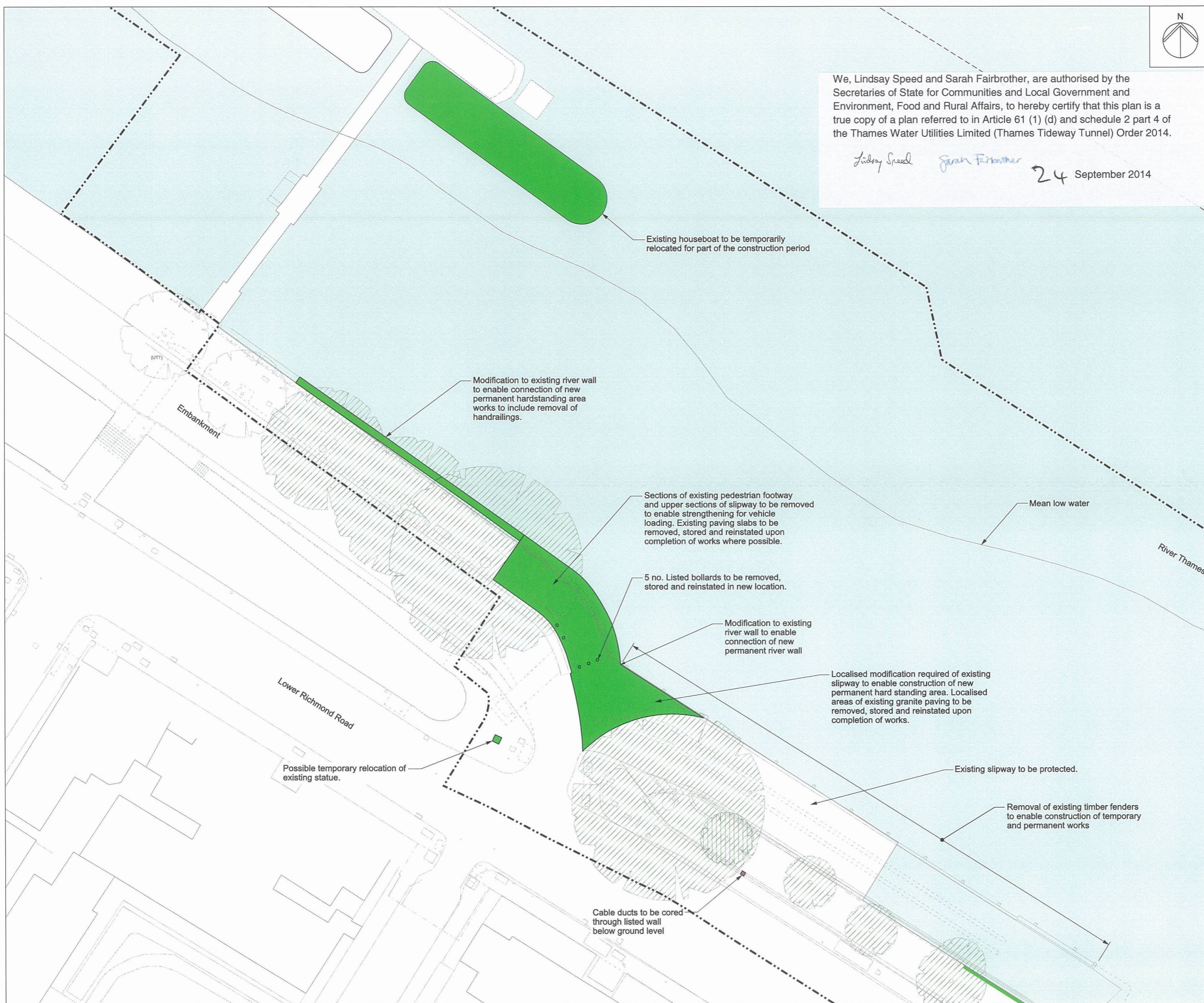

We, Lindsay Speed and Sarah Fairbrother, are authorised by the Secretaries of State for Communities and Local Government and Environment, Food and Rural Affairs, to hereby certify that this plan is a true copy of a plan referred to in Article 61 (1) (d) and schedule 2 part 4 of the Thames Water Utilities Limited (Thames Tideway Tunnel) Order 2014.

Lindsay Speed *Sarah Fairbrother*

24 September 2014

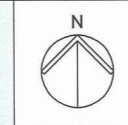

Mapping reproduced by permission of Ordnance Survey on behalf of HMSO. © Crown Copyright and Database right 2012. All rights reserved. Ordnance Survey licence number 100019345



Coordinates are to be Ordnance Survey Datum OSGB36. All levels are in metres and relate to the Tunnel Datum which is 100 metres below Ordnance Datum Newlyn.

Key:

	Limits of land to be acquired or used (LLAU)
	Trees to be removed
	Trees to be pruned
	Below ground structures to be removed or infilled
	Structure to be removed and relocated or reinstated

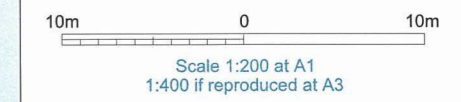
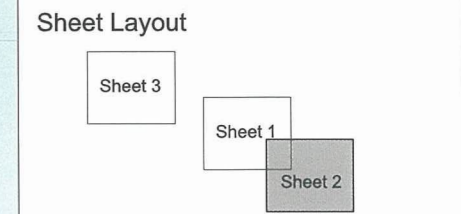

FOR APPROVAL

- Notes:**
1. Area of foreshore will require dredging prior to formation of temporary working area.
 2. Formation of temporary working area not illustrated, refer to construction phasing layout drawings.
 3. Minor items to be removed (e.g. barriers, bollards etc.) are not shown.
 4. General activities of site clearance such as removal of hardstanding and foundations, stripping of topsoil and clearance of minor vegetation not shown.

Location
Putney Embankment Foreshore
London Borough of Wandsworth

Document Information
Application for Development Consent
Demolition and site clearance
Sheet 2 of 3
Book of plans - section 8
DCO-PP-05X-PUTEF-080006
January 2013

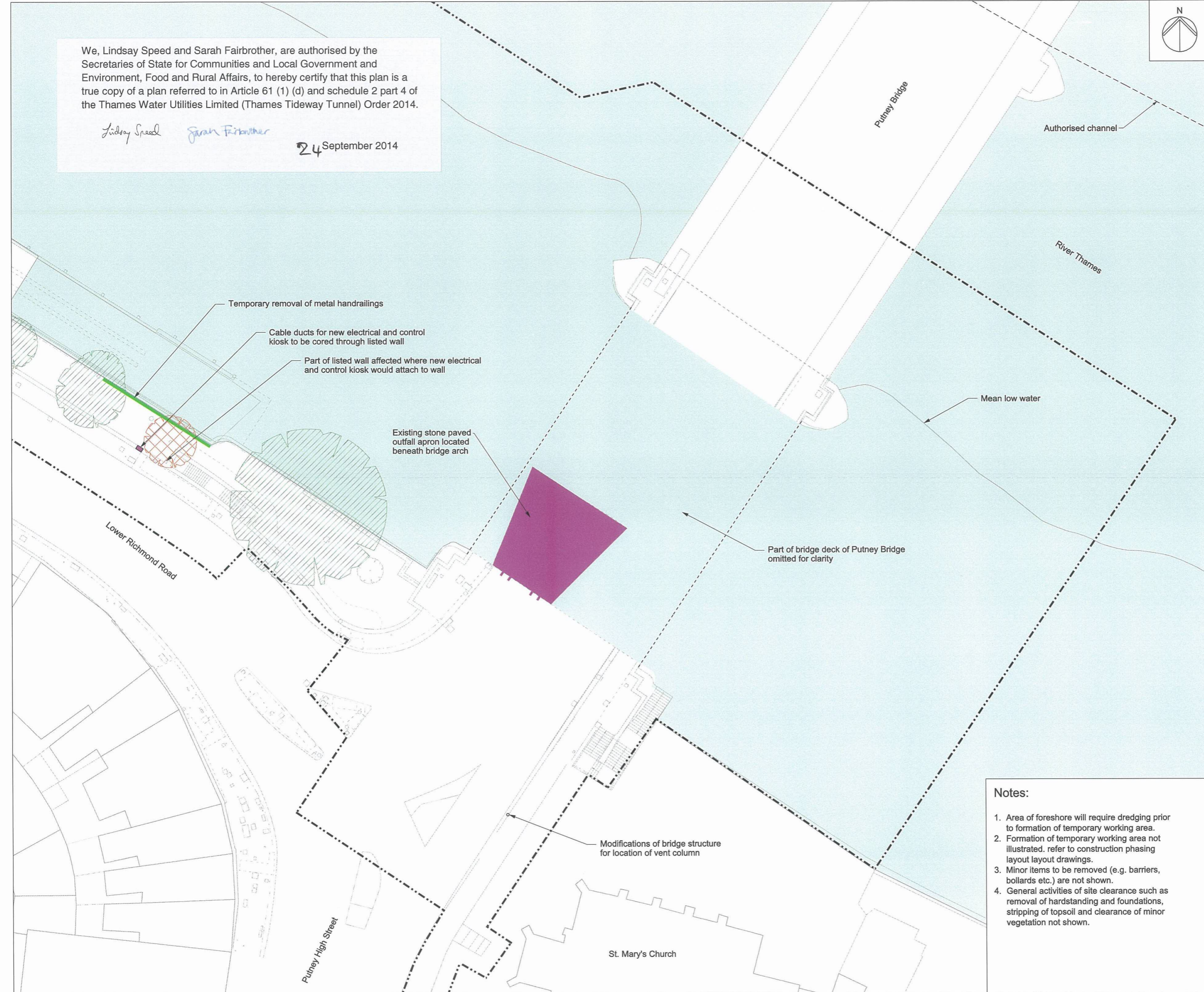

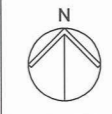



Mapping reproduced by permission of Ordnance Survey on behalf of HMSO. © Crown Copyright and Database right 2012. All rights reserved. Ordnance Survey licence number 100019345



Coordinates are to be Ordnance Survey Datum OSGB36. All levels are in metres and relate to the Tunnel Datum which is 100 metres below Ordnance Datum Newlyn.

- Key:**
-  Limits of land to be acquired or used (LLAU)
 -  Trees to be pruned
 -  Structure to be removed and relocated or reinstated

- Notes:**
1. Minor items to be removed (e.g. barriers, bollards etc.) are not shown.
 2. Formation of temporary working area not illustrated. refer to construction phasing layout layout drawings.
 3. General activities of site clearance such as removal of hardstanding and foundations, stripping of topsoil and clearance of minor vegetation not shown.

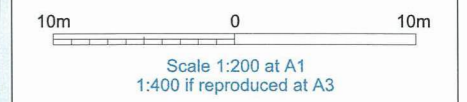
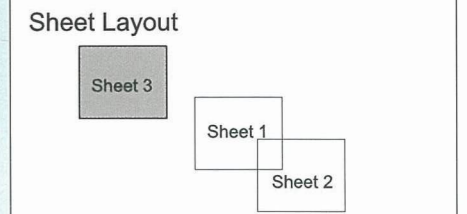

FOR APPROVAL

Location
Putney Embankment Foreshore
London Borough of Wandsworth

Document Information
Application for Development Consent
Demolition and site clearance
Sheet 3 of 3
Book of plans - section 8
DCO-PP-05X-PUTEF-080007
January 2013



We, Lindsay Speed and Sarah Fairbrother, are authorised by the Secretaries of State for Communities and Local Government and Environment, Food and Rural Affairs, to hereby certify that this plan is a true copy of a plan referred to in Article 61 (1) (d) and schedule 2 part 4 of the Thames Water Utilities Limited (Thames Tideway Tunnel) Order 2014.

Lindsay Speed *Sarah Fairbrother*

24 September 2014

Mapping reproduced by permission of Ordnance Survey on behalf of HMSO. © Crown Copyright and Database right 2014. All rights reserved. Ordnance Survey licence number 100019345



Coordinates are to be Ordnance Survey Datum OSGB36. All levels are in metres and relate to the Tunnel Datum which is 100 metres below Ordnance Datum Newlyn.

- Key:**
- Limits of land to be acquired or used (LLAU)
 - Zone within which all permanent site structures would be located
 - Zone within which the shaft would be located
 - Zone within which permanent above ground structures would be located (those listed in Table 1)
 - Zone within which required landscaping would be located
 - Maximum extent of top of river/parapet wall
 - Maximum extent of temporary works platform

- Notes:**
1. All dimensions and levels are approximate.
 2. The Site Works Parameter Key Plan identifies each zone independently.
 3. The zone within which the shaft would be located would include all permanent works including shaft walls (including appropriate allowances for construction tolerances) and if applicable under-reaming. Shaft construction temporary works may be located within or outside this zone provided they are located within the Limits of land to be acquired or used.

Rev 1:

1. Maximum height of ventilation column(s) serving the shaft reduced in table 1.

10m 0 100m
Scale 1:1000 at A1
1:2000 if reproduced at A3

10m 0 40m
Scale 1:500 at A1
1:1000 if reproduced at A3

FOR APPROVAL

Location
Putney Embankment Foreshore
London Borough of Wandsworth

Document Information
Application for Development Consent
Site works parameter plan

Book of plans - section 8
DCO-PP-05X-PUTEF-080008 - Rev 1
March 2014



© Thames Water Utilities Ltd 2014

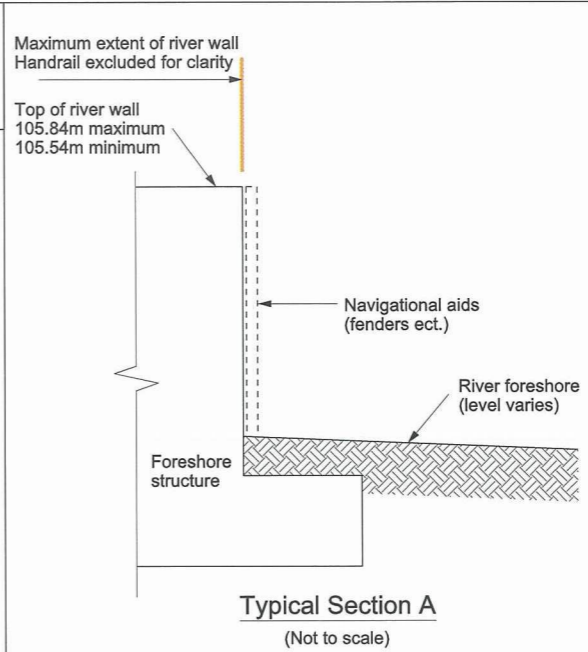
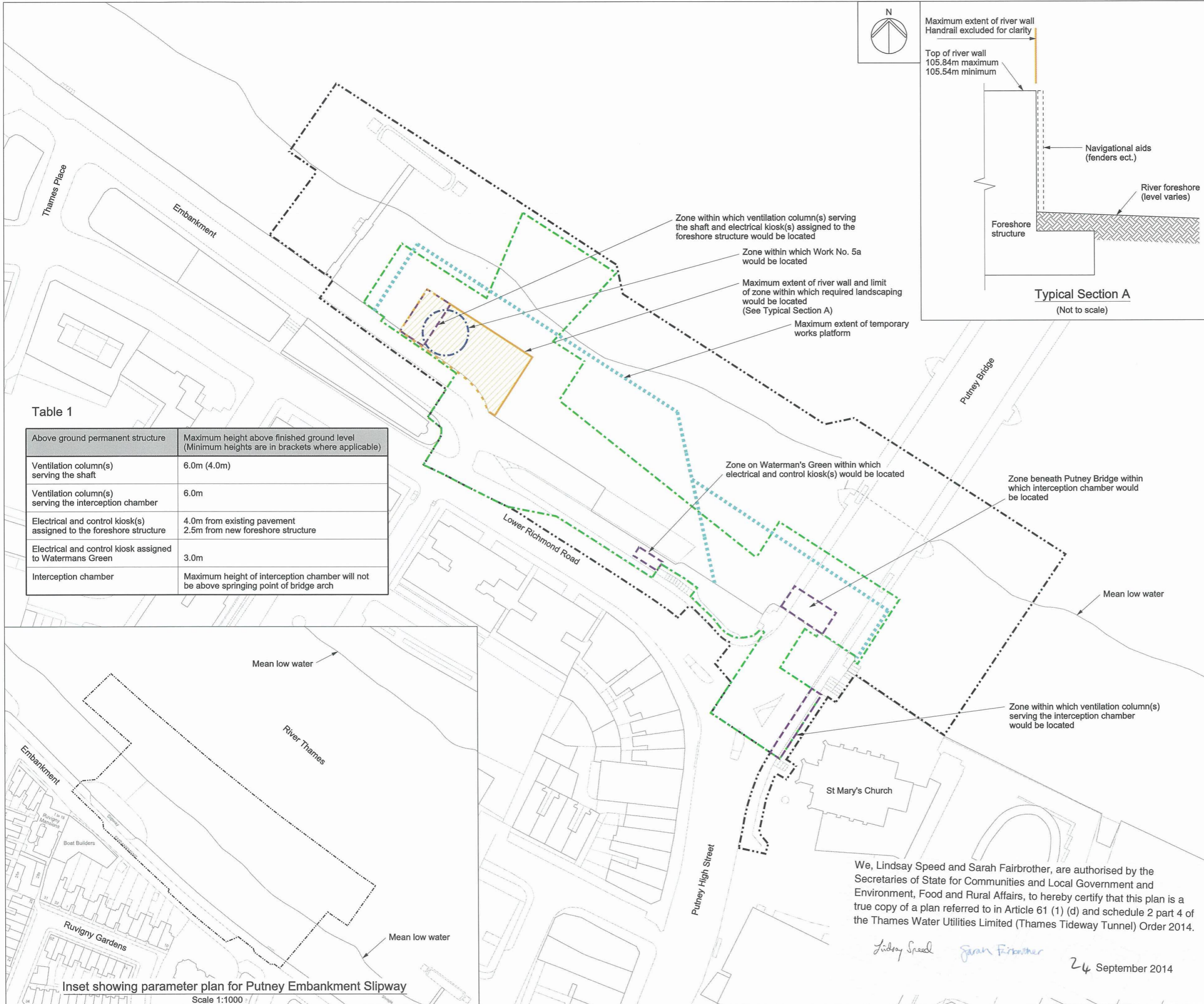
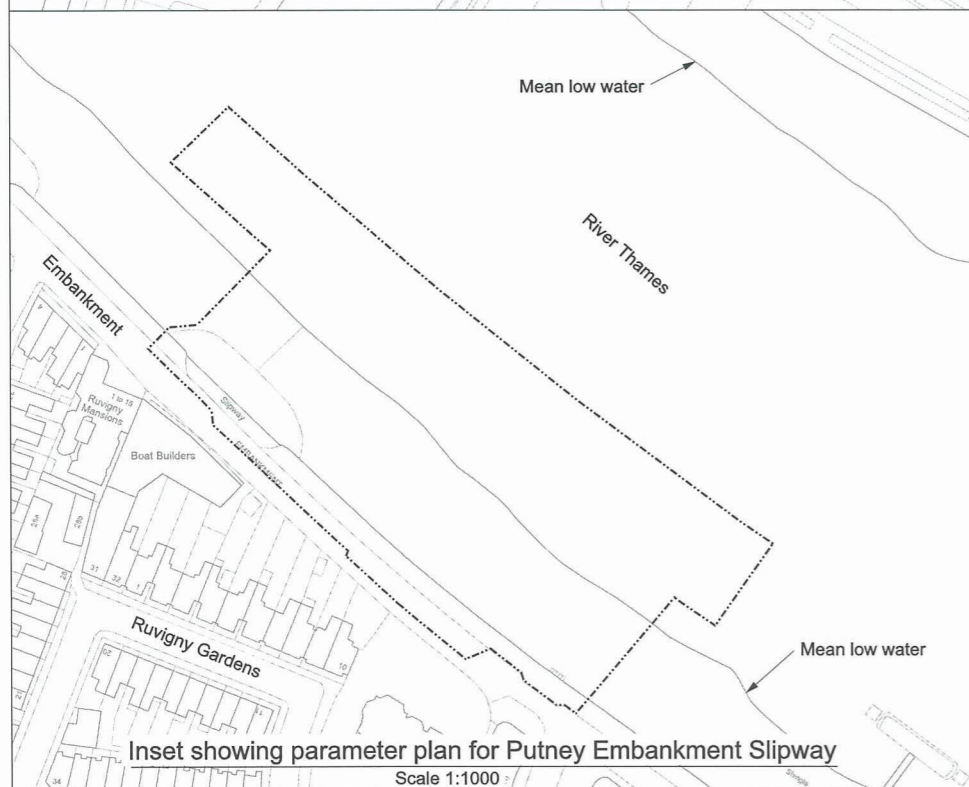

Table 1

Above ground permanent structure	Maximum height above finished ground level (Minimum heights are in brackets where applicable)
Ventilation column(s) serving the shaft	6.0m (4.0m)
Ventilation column(s) serving the interception chamber	6.0m
Electrical and control kiosk(s) assigned to the foreshore structure	4.0m from existing pavement 2.5m from new foreshore structure
Electrical and control kiosk assigned to Watermans Green	3.0m
Interception chamber	Maximum height of interception chamber will not be above springing point of bridge arch



We, Lindsay Speed and Sarah Fairbrother, are authorised by the Secretaries of State for Communities and Local Government and Environment, Food and Rural Affairs, to hereby certify that this plan is a true copy of a plan referred to in Article 61 (1) (d) and schedule 2 part 4 of the Thames Water Utilities Limited (Thames Tideway Tunnel) Order 2014.

Lindsay Speed *Sarah Fairbrother*
24 September 2014

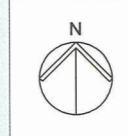

Mapping reproduced by permission of Ordnance Survey on behalf of HMSO. © Crown Copyright and Database right 2012. All rights reserved. Ordnance Survey licence number 100019345



Coordinates are to be Ordnance Survey Datum OSGB36. All levels are in metres and relate to the Tunnel Datum which is 100 metres below Ordnance Datum Newlyn.

- Key:**
- Limits of land to be acquired or used (LLAU)
 - Existing Level (shown in metres above tunnel datum)
 - Proposed level (shown in metres above tunnel datum)

- Notes:**
1. All dimensions and levels are approximate.
 2. Any discrepancy between the location of structures and the parameters marked on the drawings are due to differences between the Ordnance Survey base and topographical survey base, both of which have been used in the preparation of this drawing.
 3. This drawing shows permanent site structures only. Landscaping hard works and soft works are shown on the Proposed landscape plan and/or Proposed site features plan.
 4. This slipway is to be provided as a temporary replacement for the slipway at Putney Embankment foreshore site. It is proposed that this temporary slipway be removed once work at the Putney Embankment foreshore site is complete.

We, Lindsay Speed and Sarah Fairbrother, are authorised by the Secretaries of State for Communities and Local Government and Environment, Food and Rural Affairs, to hereby certify that this plan is a true copy of a plan referred to in Schedule 3 of the Thames Water Utilities Limited (Thames Tideway Tunnel) Order 2014.

Lindsay Speed *Sarah Fairbrother*

24 September 2014

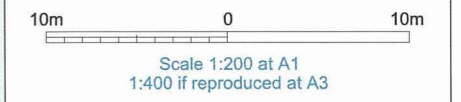

INDICATIVE

Location
Putney Embankment Foreshore
 London Borough of Wandsworth

Document Information
Application for Development Consent
 Temporary slipway layout

Book of plans - section 8
 DCO-PP-05X-PUTEF-080012
 January 2013

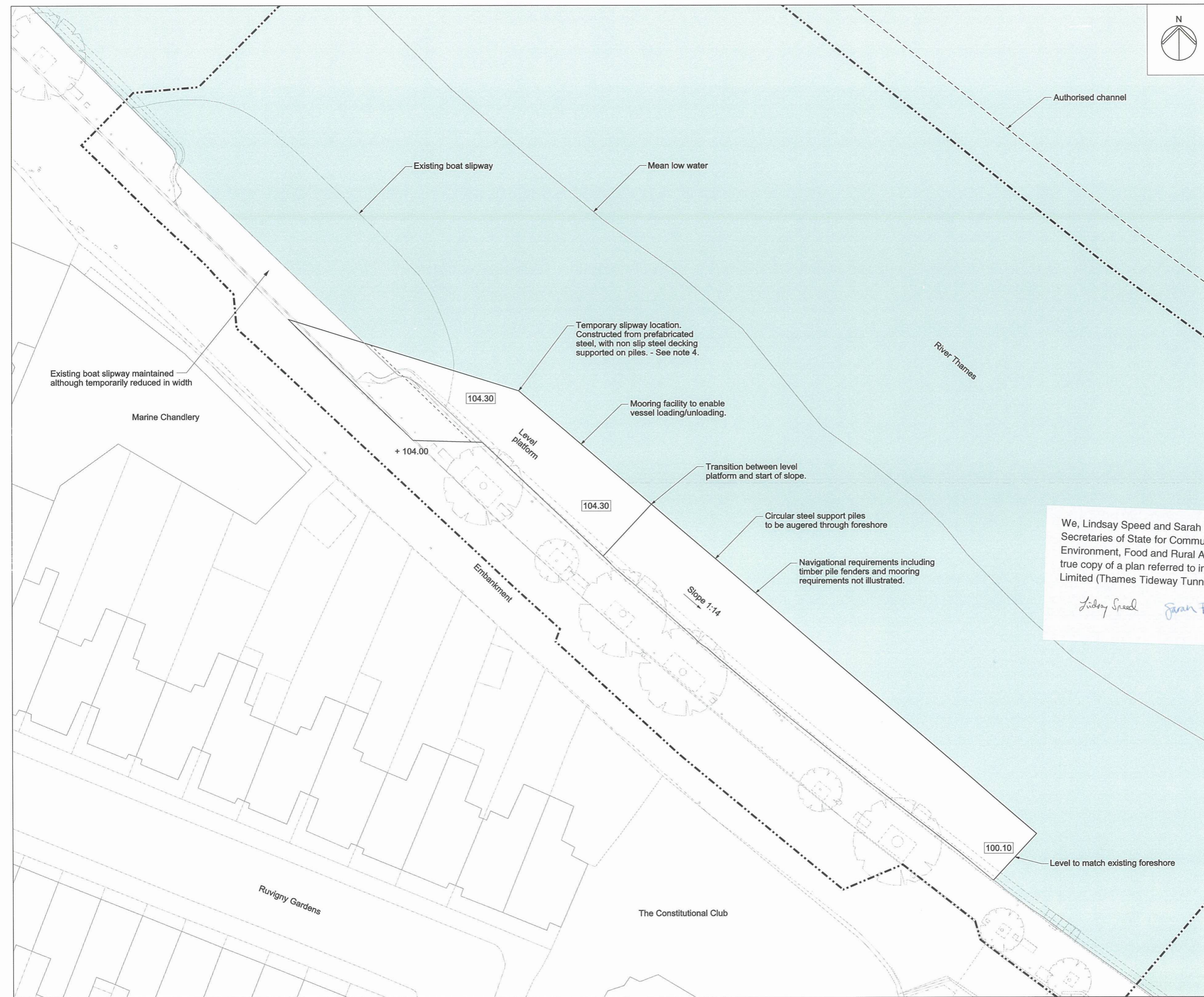

We, Lindsay Speed and Sarah Fairbrother, are authorised by the Secretaries of State for Communities and Local Government and Environment, Food and Rural Affairs, to hereby certify that this plan is a true copy of a plan referred to in Schedule 3 of the Thames Water Utilities Limited (Thames Tideway Tunnel) Order 2014.

Lindsay Speed Sarah Fairbrother
24 September 2014



Mapping reproduced by permission of Ordnance Survey on behalf of HMSO. © Crown Copyright and Database right 2014. All rights reserved. Ordnance Survey licence number 100019345



Coordinates are to be Ordnance Survey Datum OSGB36. All levels are in metres and relate to the Tunnel Datum which is 100 metres below Ordnance Datum Newlyn.

- Key:**
- Limits of land to be acquired or used (LLAU)
 - - - Zone within which permanent above ground structures would be located
 - - - Zone within which required landscaping would be located
 - Maximum extent of foreshore structure
 - + 105.40m Existing levels (shown in metres above tunnel datum)
 - 105.40 Proposed levels (shown in metres above tunnel datum)
 - * Listed buildings/structures
 - Approximate position of CSO outlet
 - ⊙ Existing trees within surveyed area (trunk sizes vary)

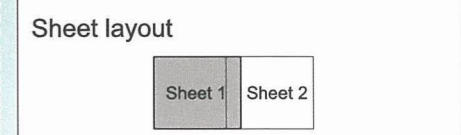

Rev 1:

- Maximum height of signature ventilation column(s) reduced.

10m 0 10m
Scale 1:200 at A1
1:400 if reproduced at A3

INDICATIVE
Save for layout of above ground structures which is illustrative

Location
Putney Embankment Foreshore
London Borough of Wandsworth

Document Information
Application for Development Consent
Proposed
Landscape plan sheet 1 of 2
Book of plans - section 8
DCO-PP-05X-PUTEF-080013 - Rev 1
March 2014



- Landscape key:**
- Granite Plank paving 200mm wide varying in length
 - Proposed cobbles to match existing
 - Existing listed bollards relocated
 - Proposed drop down/removable bollards
 - Proposed flush strip LED ground lighting

Notes:

- All dimensions and levels are approximate.
- Any discrepancy between the location of structures and the parameters marked on the drawings are due to differences between the Ordnance Survey base and the topographic survey base, both of which have been used in the preparation of this drawing.
- The above ground structures in the "save for the layout of above ground structures which is indicative" statement are those listed in Table 1 on the Site works parameter plan.
- Access covers not shown on this drawing. Refer to the Permanent works layout for an indication of the extent of access covers required.

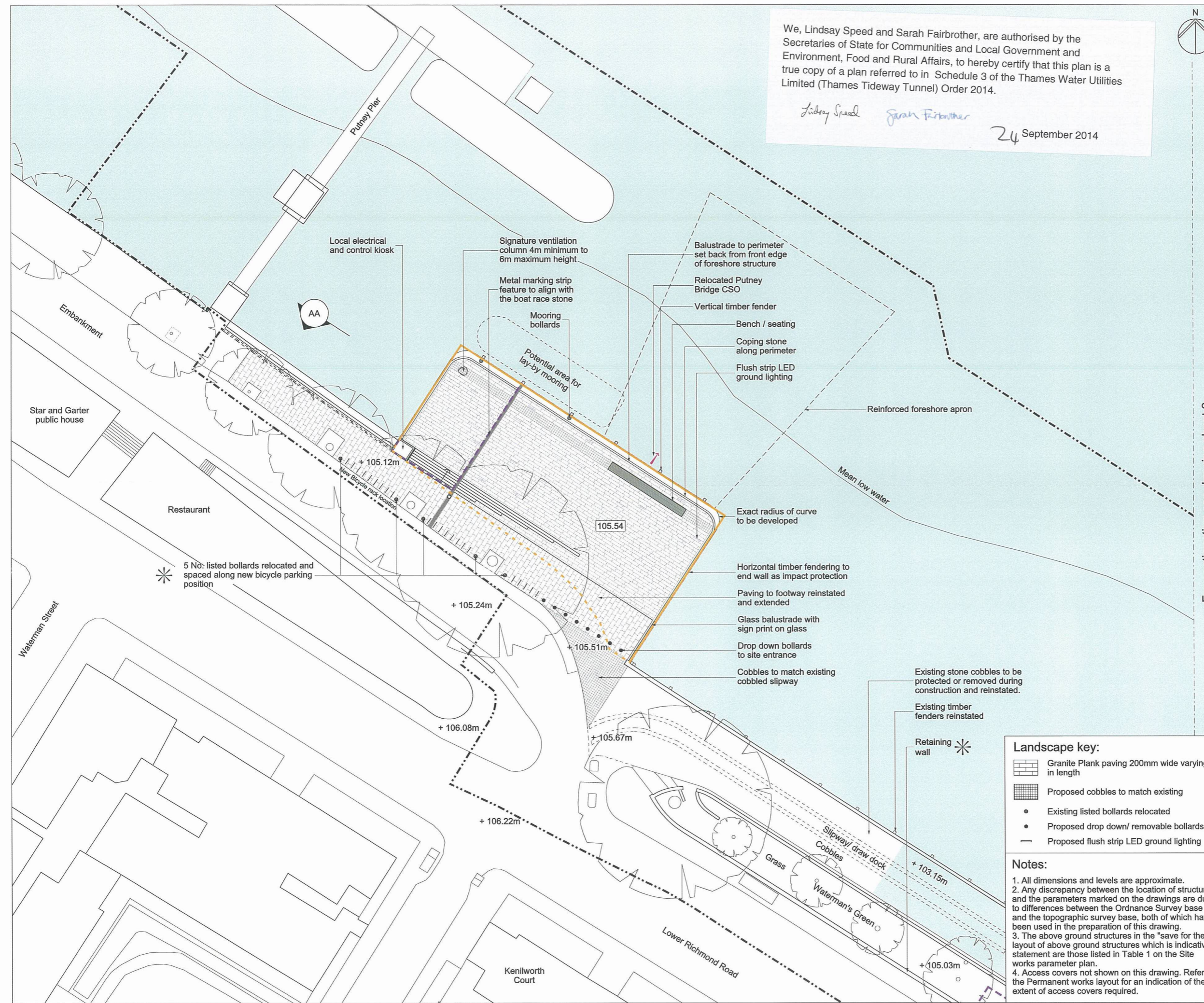

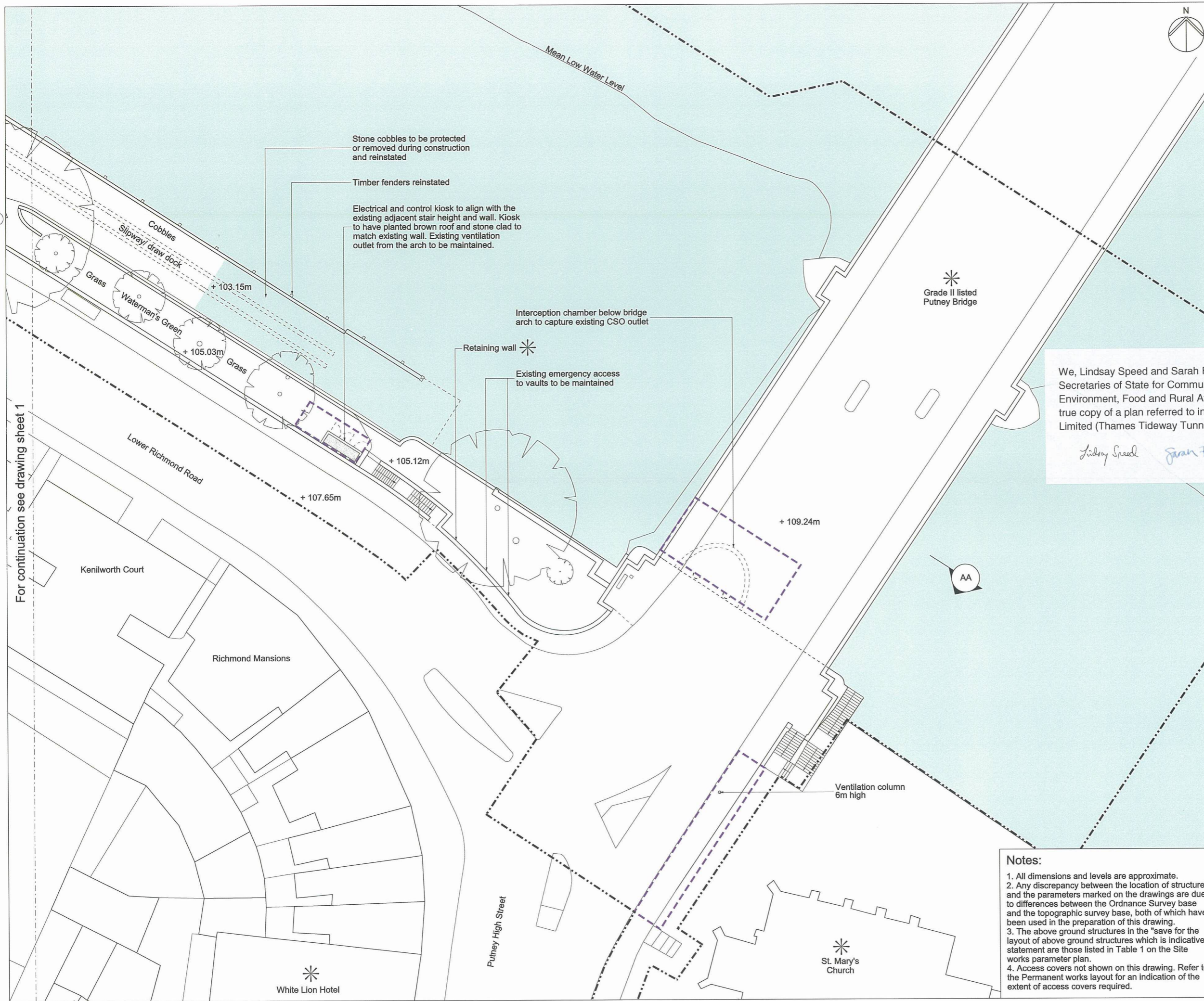

Mapping reproduced by permission of Ordnance Survey on behalf of HMSO. © Crown Copyright and Database right 2012. All rights reserved. Ordnance Survey licence number 100019345



Coordinates are to be Ordnance Survey Datum OSGB36. All levels are in metres and relate to the Tunnel Datum which is 100 metres below Ordnance Datum Newlyn.

- Key:
- Limits of land to be acquired or used (LLAU)
 - - - Zone within which permanent above ground structures would be located
 - + 105.40m Existing levels (shown in metres above tunnel datum)
 - * Listed buildings/structures
 - ⊙ Existing trees within surveyed area (trunk sizes vary)

We, Lindsay Speed and Sarah Fairbrother, are authorised by the Secretaries of State for Communities and Local Government and Environment, Food and Rural Affairs, to hereby certify that this plan is a true copy of a plan referred to in Schedule 3 of the Thames Water Utilities Limited (Thames Tideway Tunnel) Order 2014.

Lindsay Speed *Sarah Fairbrother* 24 September 2014

For continuation see drawing sheet 1

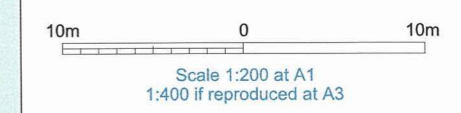
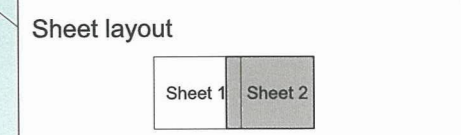

INDICATIVE
Save for layout of above ground structures which is illustrative

Location
Putney Embankment Foreshore
London Borough of Wandsworth

Document Information
Application for Development Consent
Proposed
Landscape plan sheet 2 of 2
Book of plans - section 8
DCO-PP-05X-PUTEF-080014
January 2013



- Notes:
1. All dimensions and levels are approximate.
 2. Any discrepancy between the location of structures and the parameters marked on the drawings are due to differences between the Ordnance Survey base and the topographic survey base, both of which have been used in the preparation of this drawing.
 3. The above ground structures in the "save for the layout of above ground structures which is indicative" statement are those listed in Table 1 on the Site works parameter plan.
 4. Access covers not shown on this drawing. Refer to the Permanent works layout for an indication of the extent of access covers required.

Keyplan:



Coordinates are to be Ordnance Survey Datum OSGB36. All levels are in metres and relate to the Tunnel Datum which is 100 metres below Ordnance Datum Newlyn.

Key:

Maximum permanent extent of loss of listed buildings / structures

Notes:

1. All dimensions and levels are approximate.
2. Drawing is based on as-constructed drawings and topographical survey and not on heritage survey.

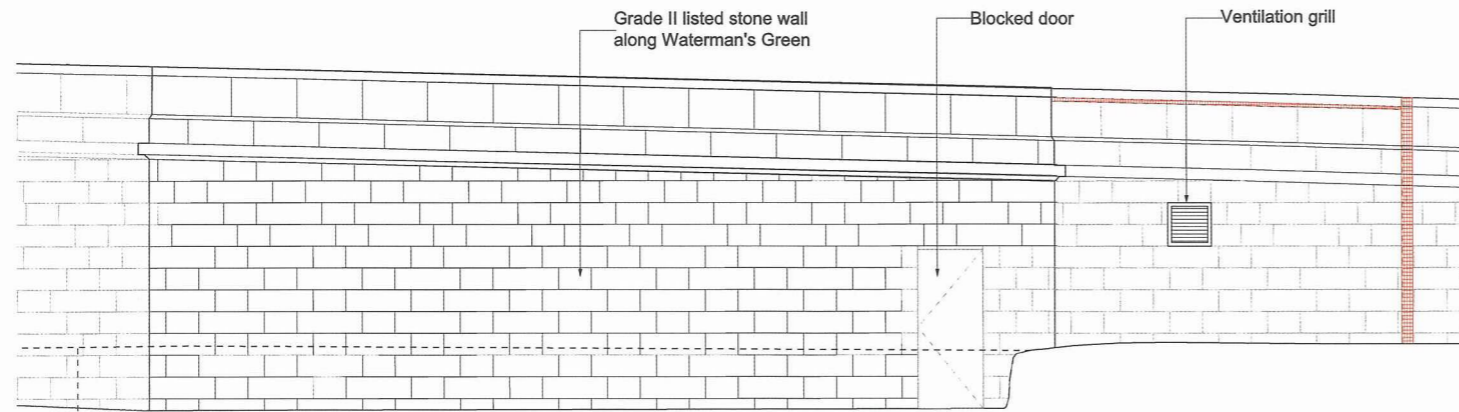

As Existing: Waterman's Green wall elevation showing extent of loss

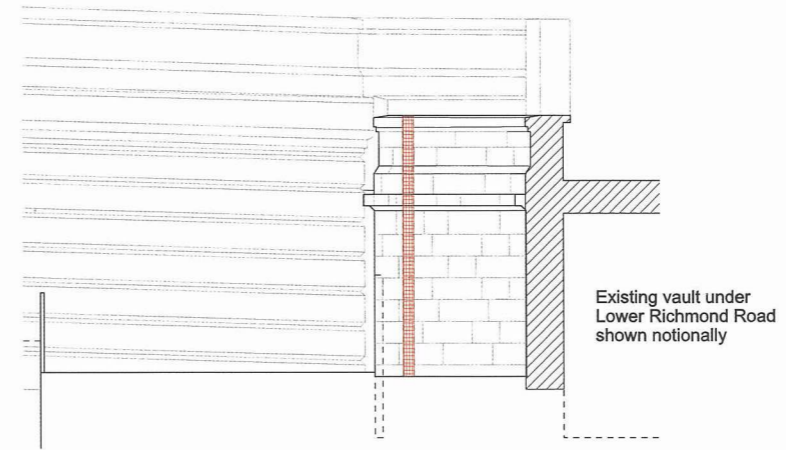

As Existing: Waterman's Green side elevation

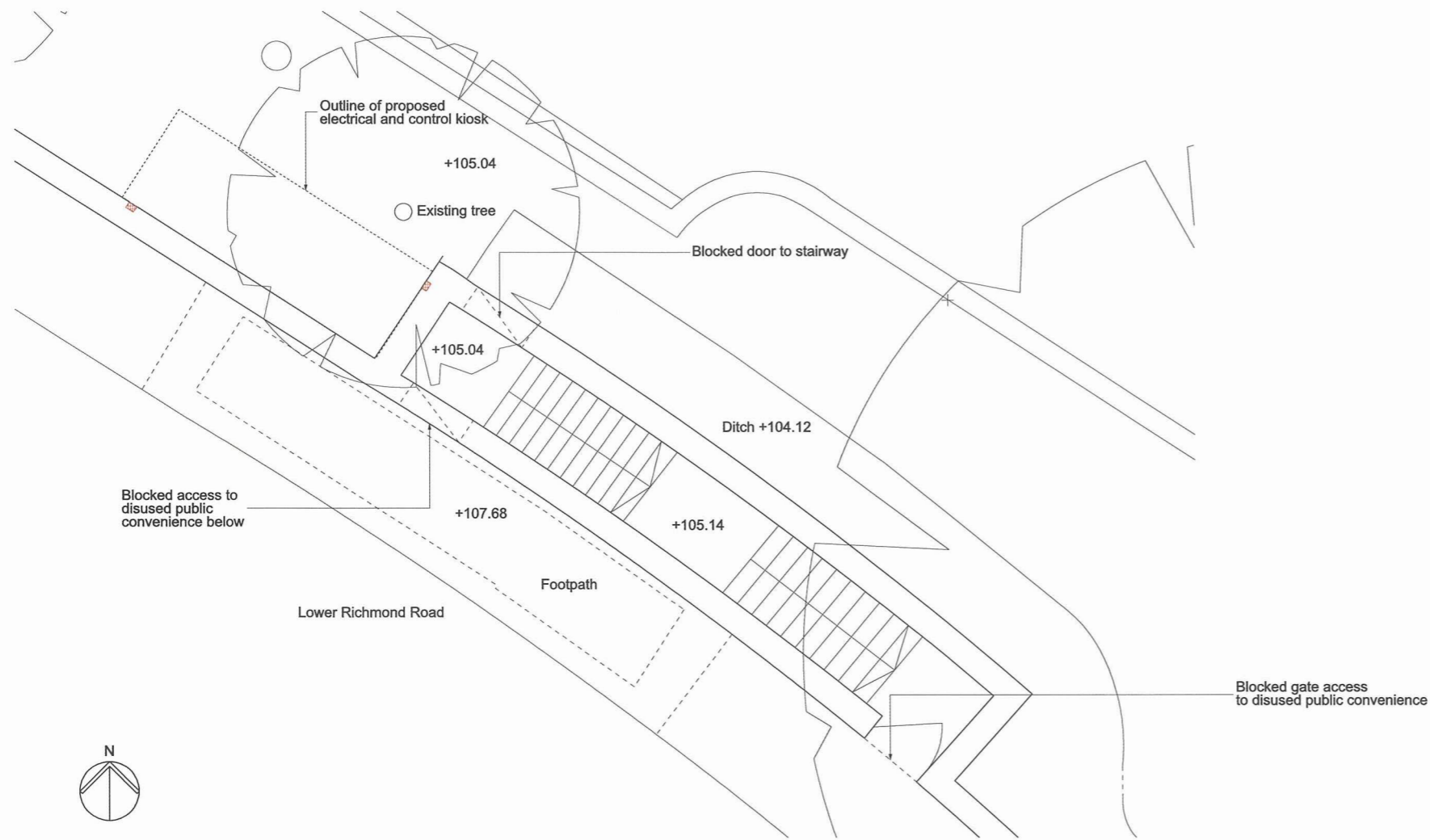

As Existing: Waterman's Green plan showing extent of loss

We, Lindsay Speed and Sarah Fairbrother, are authorised by the Secretaries of State for Communities and Local Government and Environment, Food and Rural Affairs, to hereby certify that this plan is a true copy of a plan referred to in Article 61 (1) (d) and schedule 2 part 4 of the Thames Water Utilities Limited (Thames Tideway Tunnel) Order 2014.

Lindsay Speed *Sarah Fairbrother*

24 September 2014



Scale 1:50 at A1
1:100 if reproduced at A3

FOR INFORMATION

Save for maximum extent of loss of listed structures which is for approval

Location

Putney Embankment Foreshore
London Borough of Wandsworth

Document Information

Application for Development Consent

As existing listed structure interface - Kiosk

Book of plans - section 8

DCO-PP-05X-PUTEF-080024

January 2013



Keyplan:



Coordinates are to be Ordnance Survey Datum OSGB36. All levels are in metres and relate to the Tunnel Datum which is 100 metres below Ordnance Datum Newlyn.

Notes:

1. All dimensions and levels are approximate.
2. Drawing is based on as-constructed drawings and topographical survey and not on heritage survey.

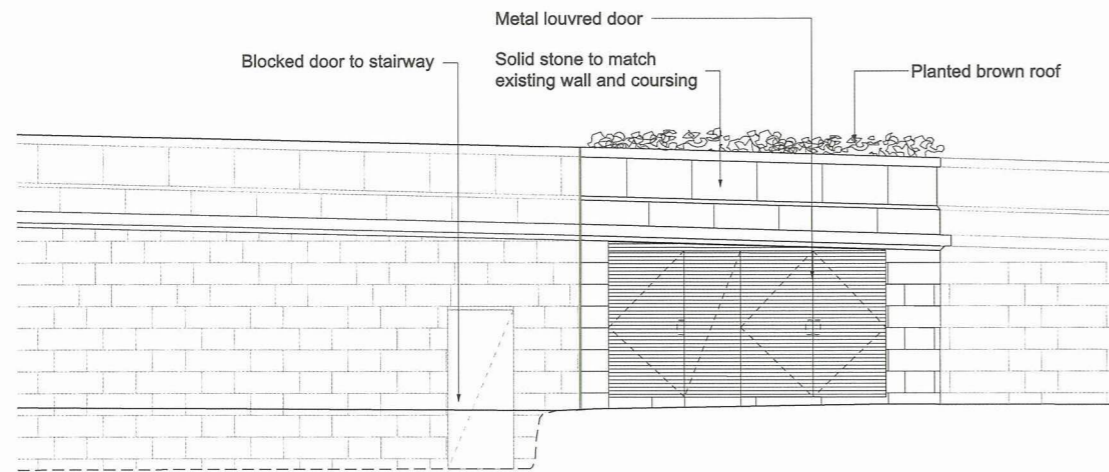

Front wall elevation

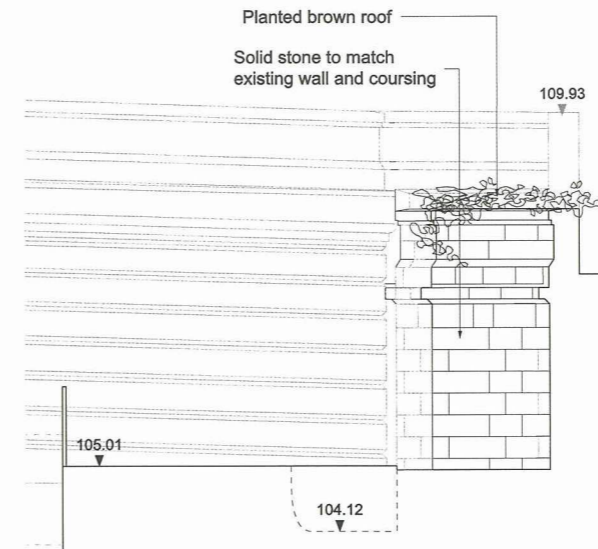

Side elevation

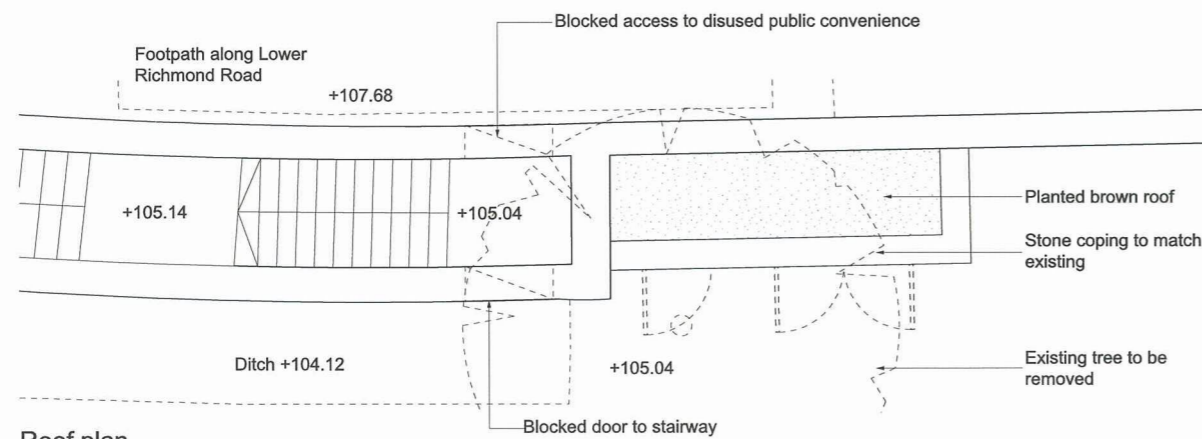

Roof plan

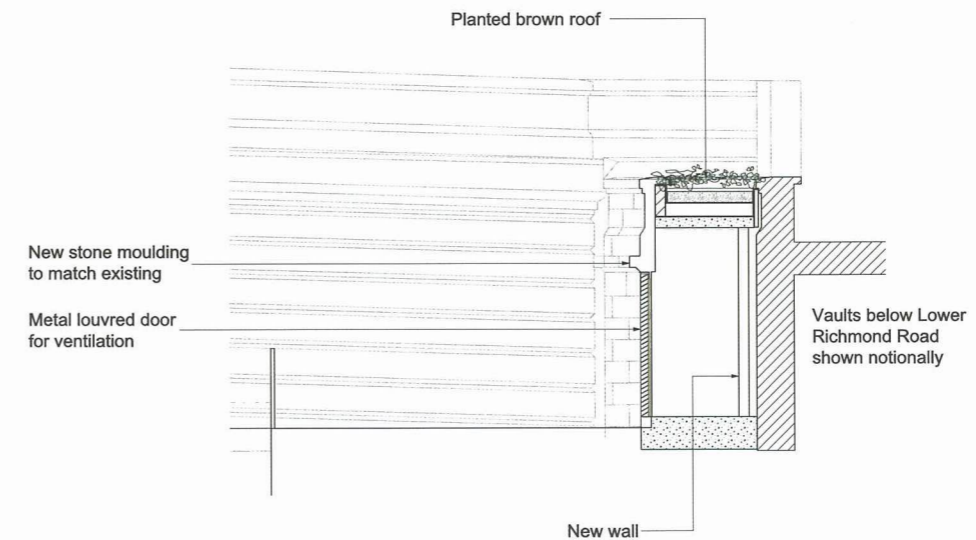

Section AA

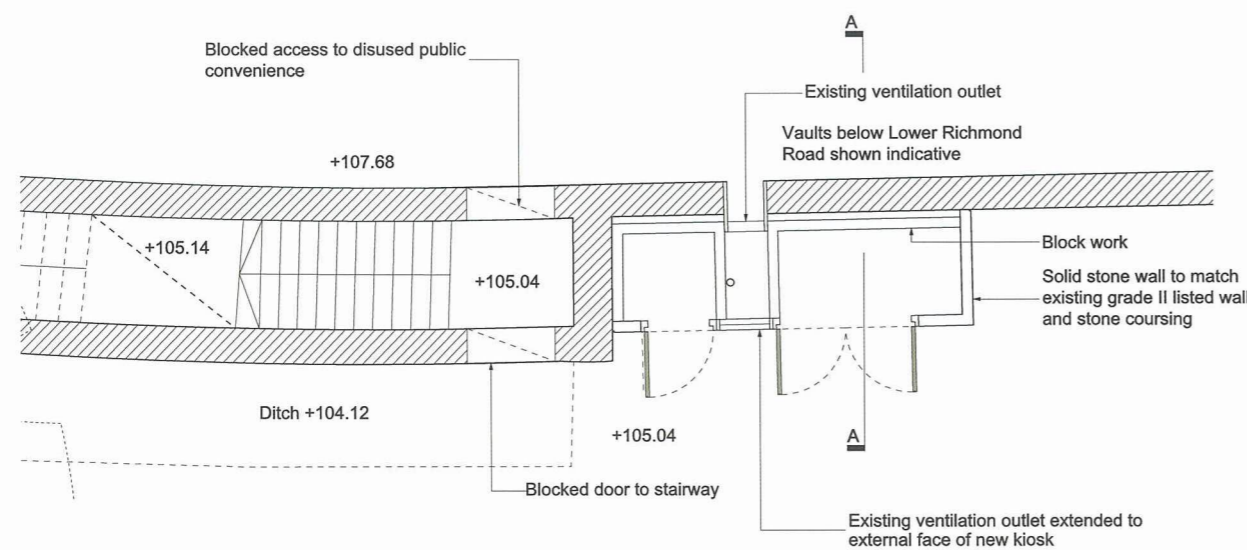

Floor plan

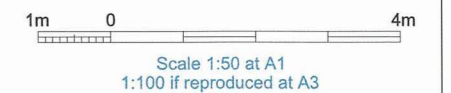

INDICATIVE

Location
Putney Embankment Foreshore
 London Borough of Wandsworth

Document Information
Application for Development Consent
 Proposed listed structure interface - Kiosk
 Book of plans - section 8
 DCO-PP-05X-PUTEF-080025
 January 2013

We, Lindsay Speed and Sarah Fairbrother, are authorised by the Secretaries of State for Communities and Local Government and Environment, Food and Rural Affairs, to hereby certify that this plan is a true copy of a plan referred to in Schedule 3 of the Thames Water Utilities Limited (Thames Tideway Tunnel) Order 2014.

Lindsay Speed *Sarah Fairbrother* 24 September 2014





Coordinates are to be Ordnance Survey Datum OSGB36. All levels are in metres and relate to the Tunnel Datum which is 100 metres below Ordnance Datum Newlyn.

Notes:
1. All dimensions and levels are approximate.

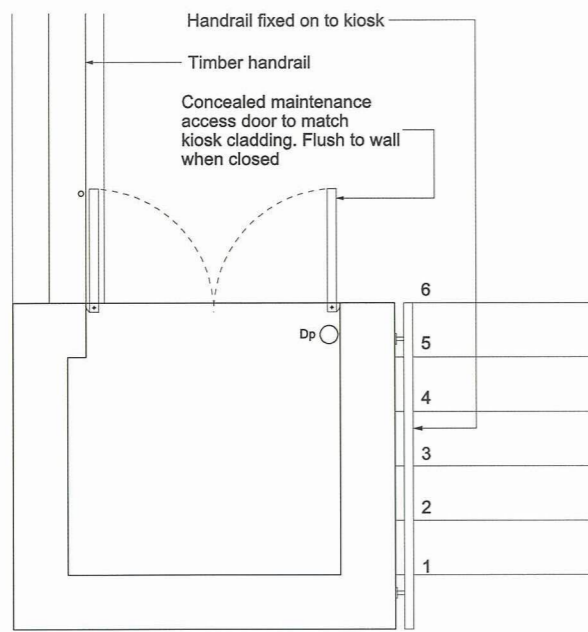

Plan

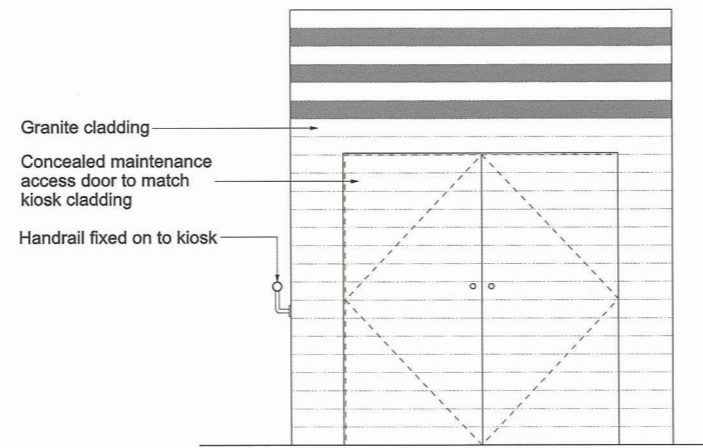

North elevation

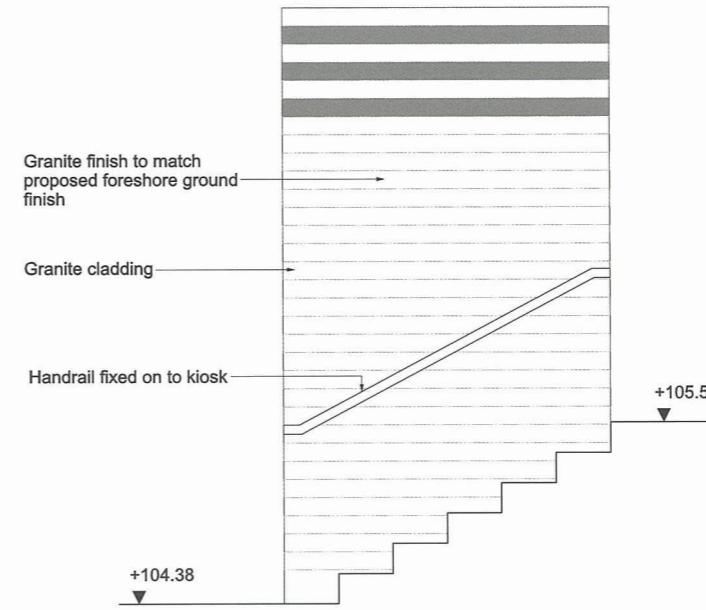

East elevation

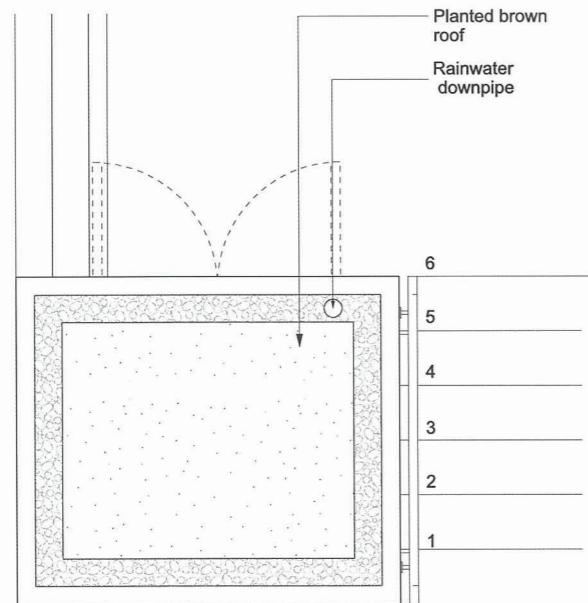

Roof plan

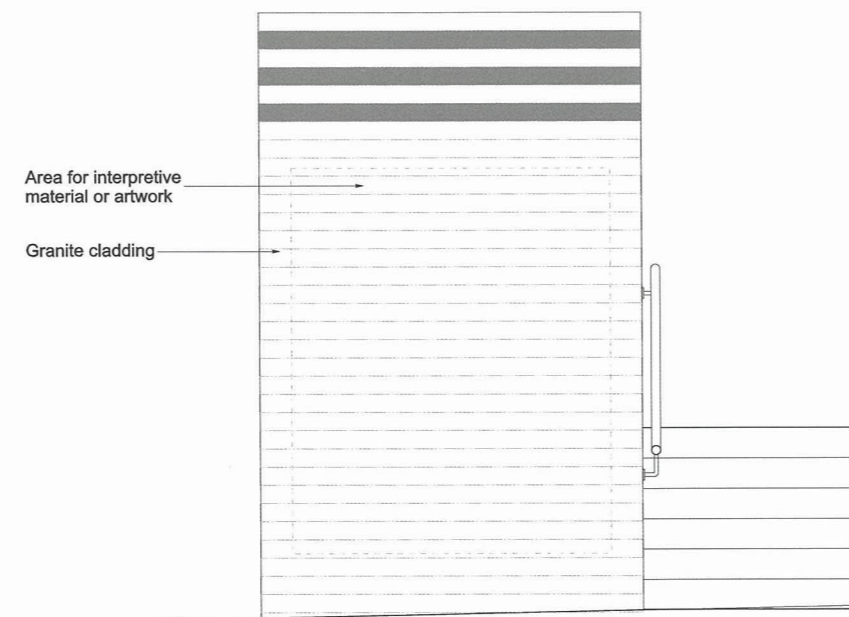

South elevation

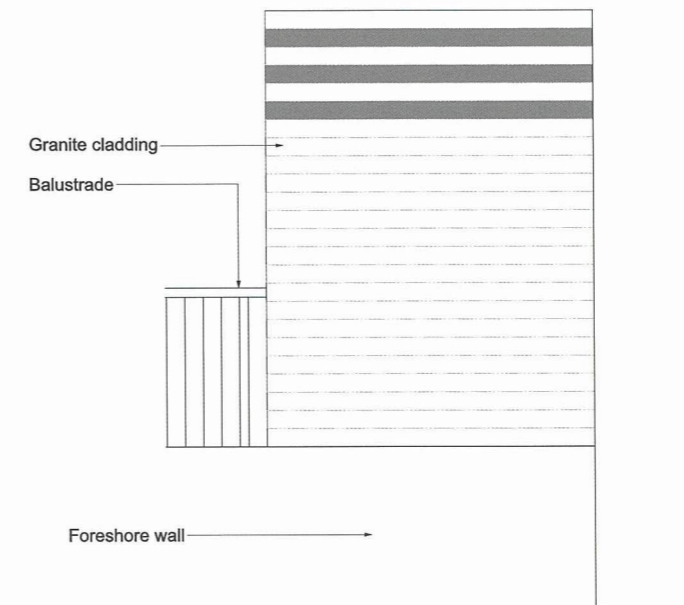

West elevation

We, Lindsay Speed and Sarah Fairbrother, are authorised by the Secretaries of State for Communities and Local Government and Environment, Food and Rural Affairs, to hereby certify that this plan is a true copy of a plan referred to in Schedule 3 of the Thames Water Utilities Limited (Thames Tideway Tunnel) Order 2014.

Lindsay Speed *Sarah Fairbrother*

24 September 2014

1m 0 1m
Scale 1:20 at A1
1:40 if reproduced at A3

INDICATIVE

Location
Putney Embankment Foreshore
London Borough of Wandsworth

Document Information
Application for Development Consent
Foreshore kiosk design intent

Book of plans - section 8
DCO-PP-05X-PUTEF-080026
January 2013



Mapping reproduced by permission of Ordnance Survey on behalf of HMSO. © Crown Copyright and Database right 2014. All rights reserved. Ordnance Survey licence number 100019345



Coordinates are to be Ordnance Survey Datum OSGB36. All levels are in metres and relate to the Tunnel Datum which is 100 metres below Ordnance Datum Newlyn.

Key:
 Maximum permanent extent of loss of listed buildings / structures

Notes:
 1. All dimensions and levels are approximate.
 2. Drawing is based on as-constructed drawings and topographical survey and not on heritage survey.

Rev 1:
 1. Maximum extent of loss for interception ventilation added.

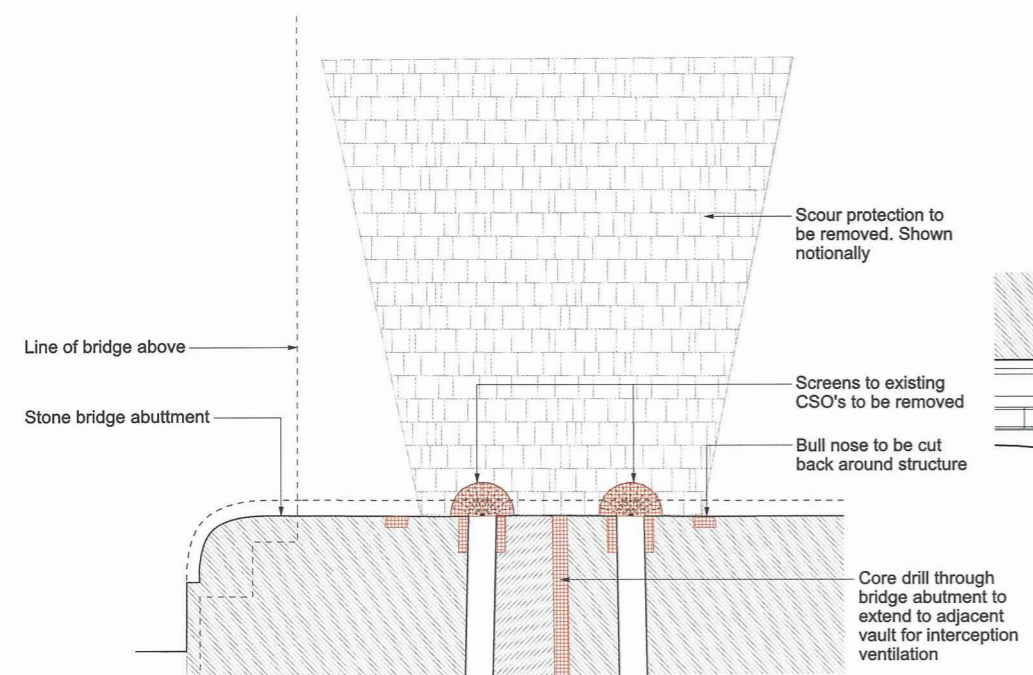

As Existing Plan

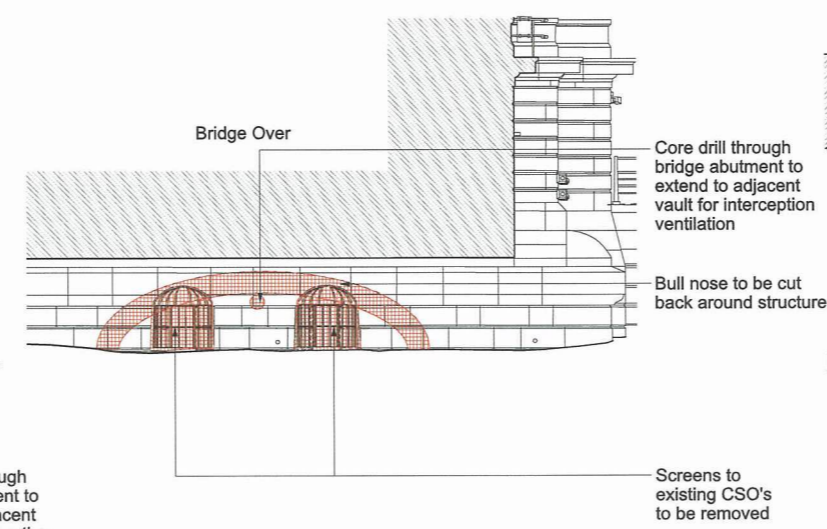

As Existing Front Elevation

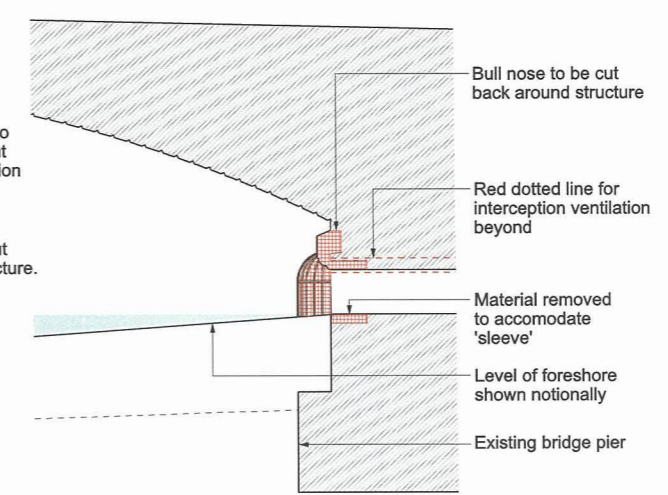

As Existing Section AA

We, Lindsay Speed and Sarah Fairbrother, are authorised by the Secretaries of State for Communities and Local Government and Environment, Food and Rural Affairs, to hereby certify that this plan is a true copy of a plan referred to in Article 61 (1) (d) and schedule 2 part 4 of the Thames Water Utilities Limited (Thames Tideway Tunnel) Order 2014.

Lindsay Speed *Sarah Fairbrother*
 24 September 2014

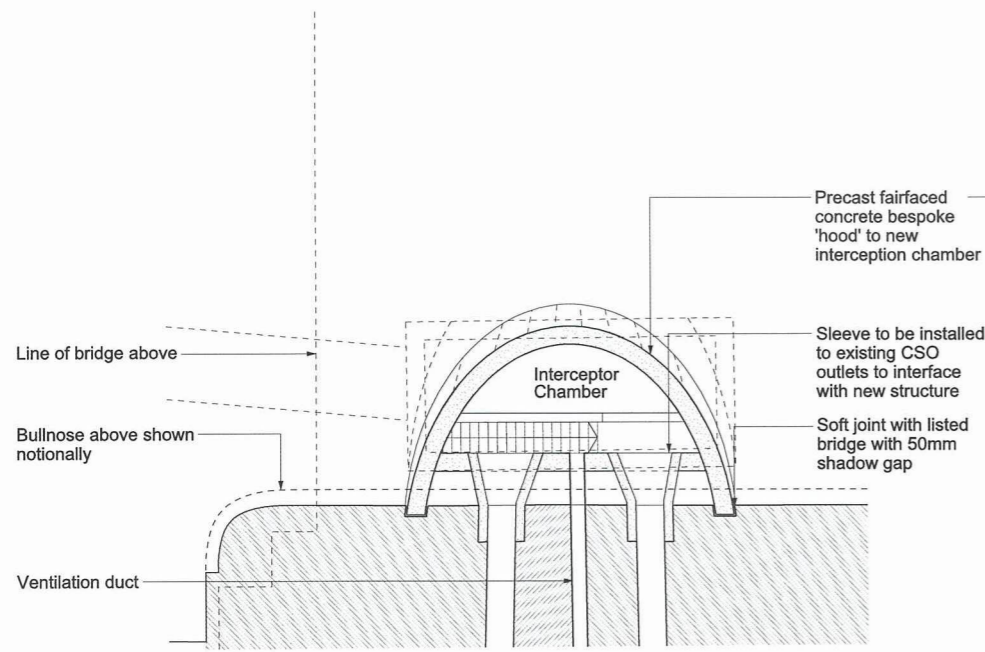

Proposed Plan

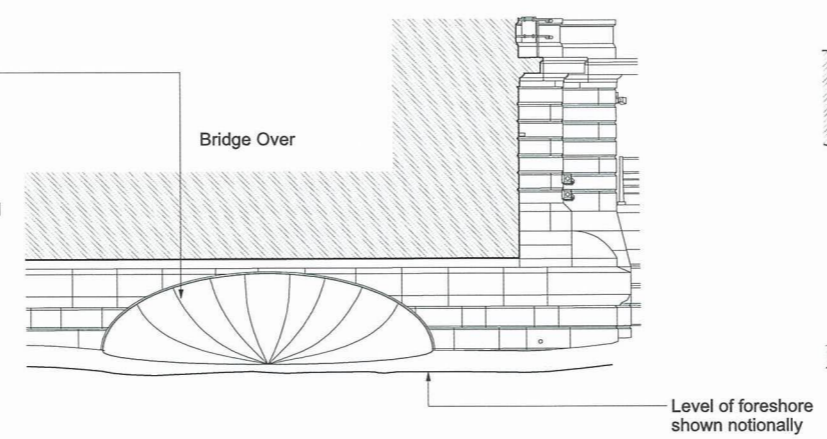

Proposed Front Elevation

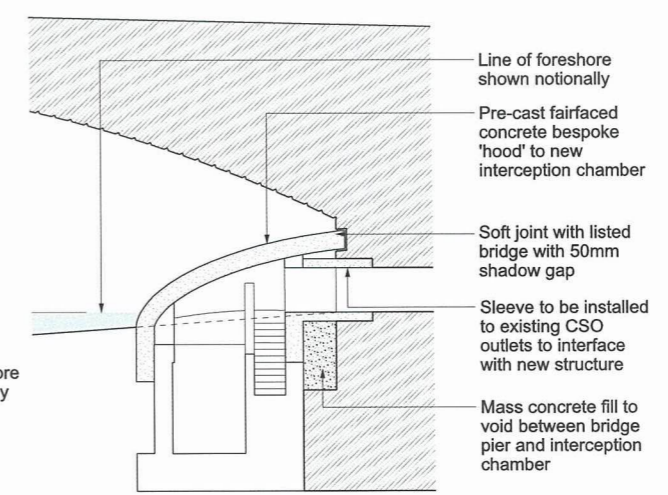

Proposed Section AA

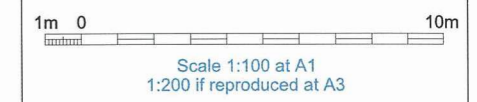

INDICATIVE
 Save for maximum extent of loss of listed structures which is for approval

Location
Putney Embankment Foreshore
 London Borough of Wandsworth

Document Information
Application for Development Consent
 Proposed listed structure interface - Interception chamber
 Book of plans - section 8
 DCO-PP-05X-PUTEF-080027 - Rev 1
 January 2014



Mapping reproduced by permission of Ordnance Survey on behalf of HMSO. © Crown Copyright and Database right 2012. All rights reserved. Ordnance Survey licence number 100019345

Keyplan:



Coordinates are to be Ordnance Survey Datum OSGB36. All levels are in metres and relate to the Tunnel Datum which is 100 metres below Ordnance Datum Newlyn.

Notes:

- 1. All dimensions and levels are approximate.

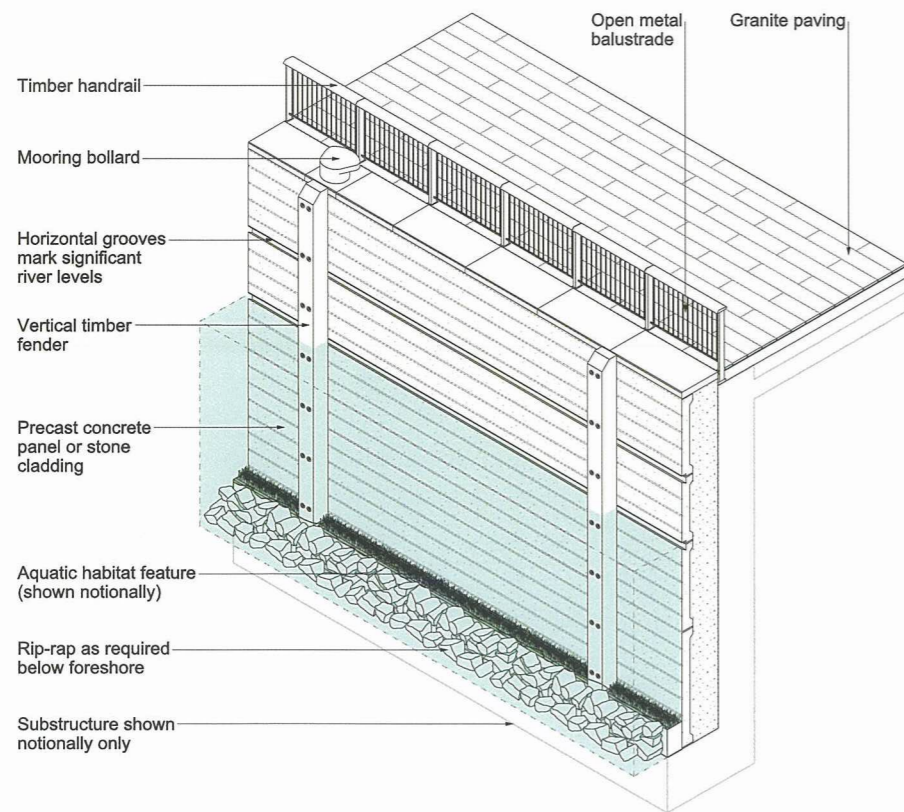

Isometric

NTS

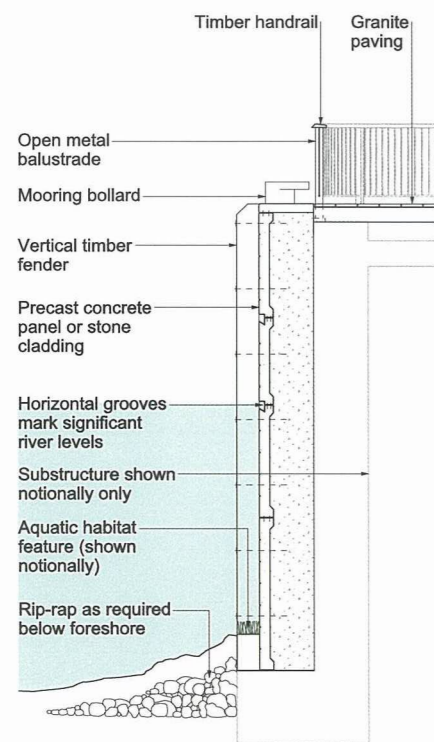

Section CC

Scale 1:50

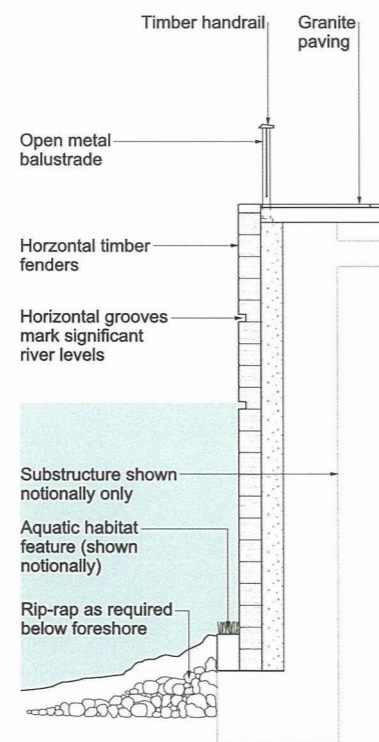

Section DD

Scale 1:50

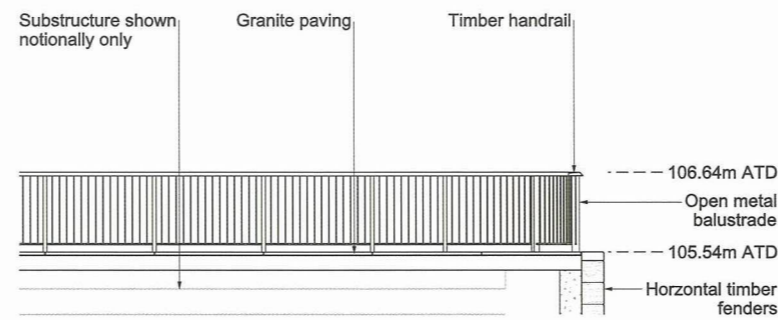

South elevation

Scale 1:50

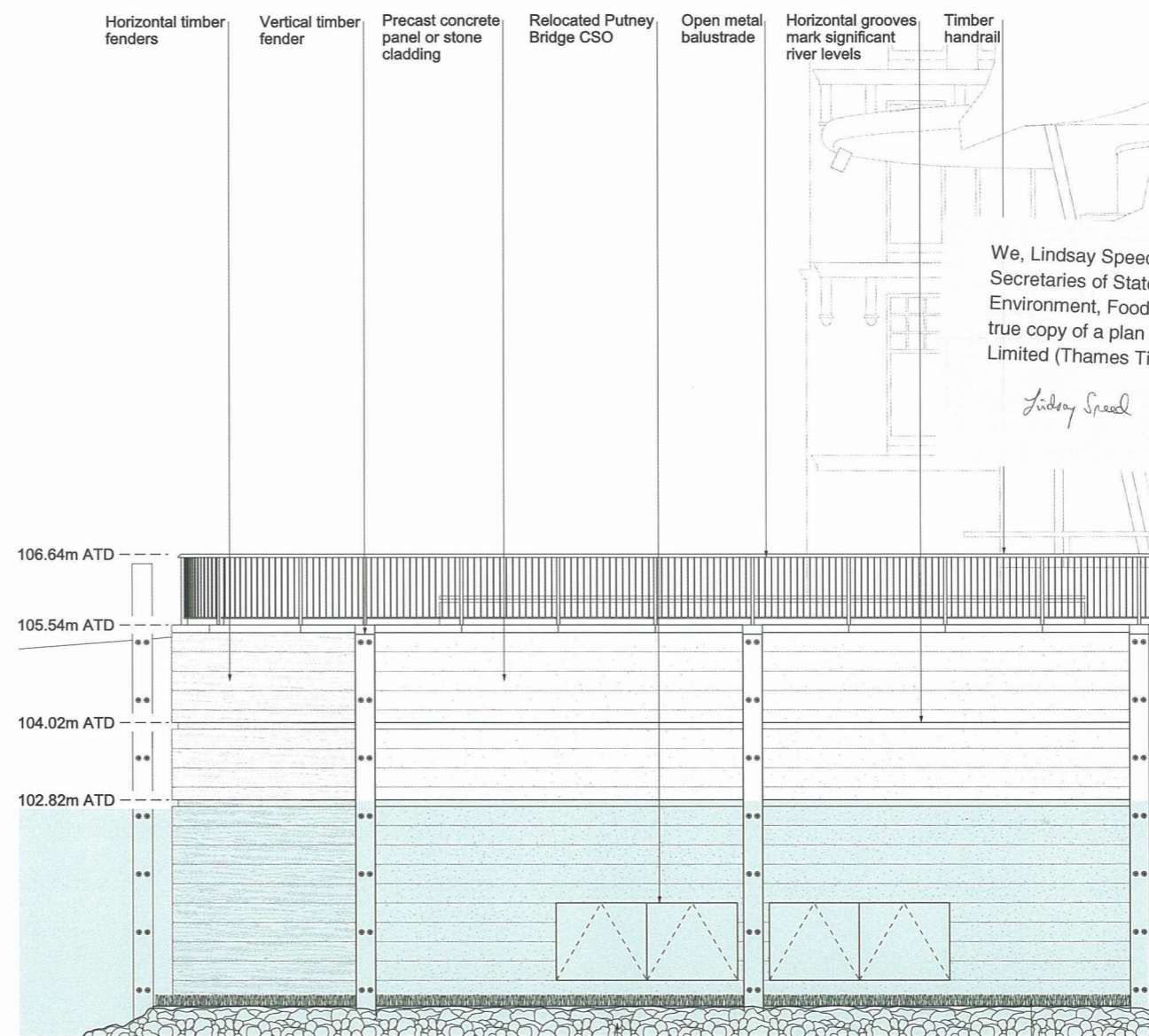

North elevation

Scale 1:50

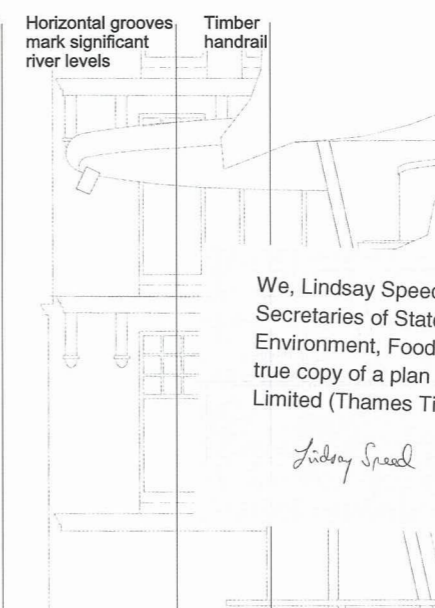
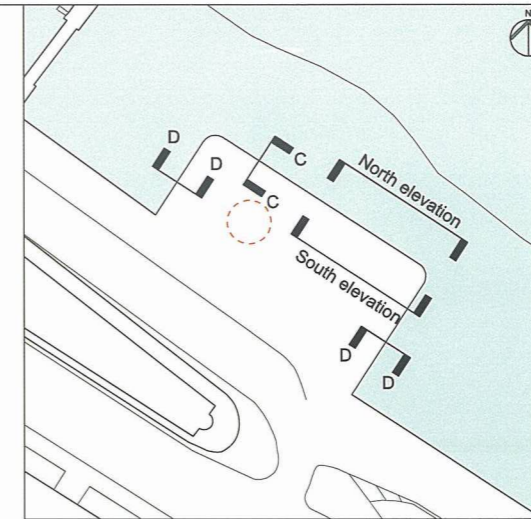

We, Lindsay Speed and Sarah Fairbrother, are authorised by the Secretaries of State for Communities and Local Government and Environment, Food and Rural Affairs, to hereby certify that this plan is a true copy of a plan referred to in Schedule 3 of the Thames Water Utilities Limited (Thames Tideway Tunnel) Order 2014.

Lindsay Speed *Sarah Fairbrother*

24 September 2014



Scale 1:50 at A1
1:100 if reproduced at A3

INDICATIVE

Location
Putney Embankment Foreshore
London Borough of Wandsworth

Document Information
Application for Development Consent
Typical river wall design intent

Book of plans - section 8
DCO-PP-05X-PUTEF-080028
January 2013

