

# CHAMBERS WHARF

Online Community Liaison Working Group

Monday 1st February 2021



Tideway





# CONSTRUCTION UPDATE



Tideway



# TBM 'URSULA' BREAKTHROUGH



<https://vimeo.com/485852785/114b60f454>



# TBM 'URSULA' BREAKTHROUGH





# TBM 'SELINA' MAKING WAY

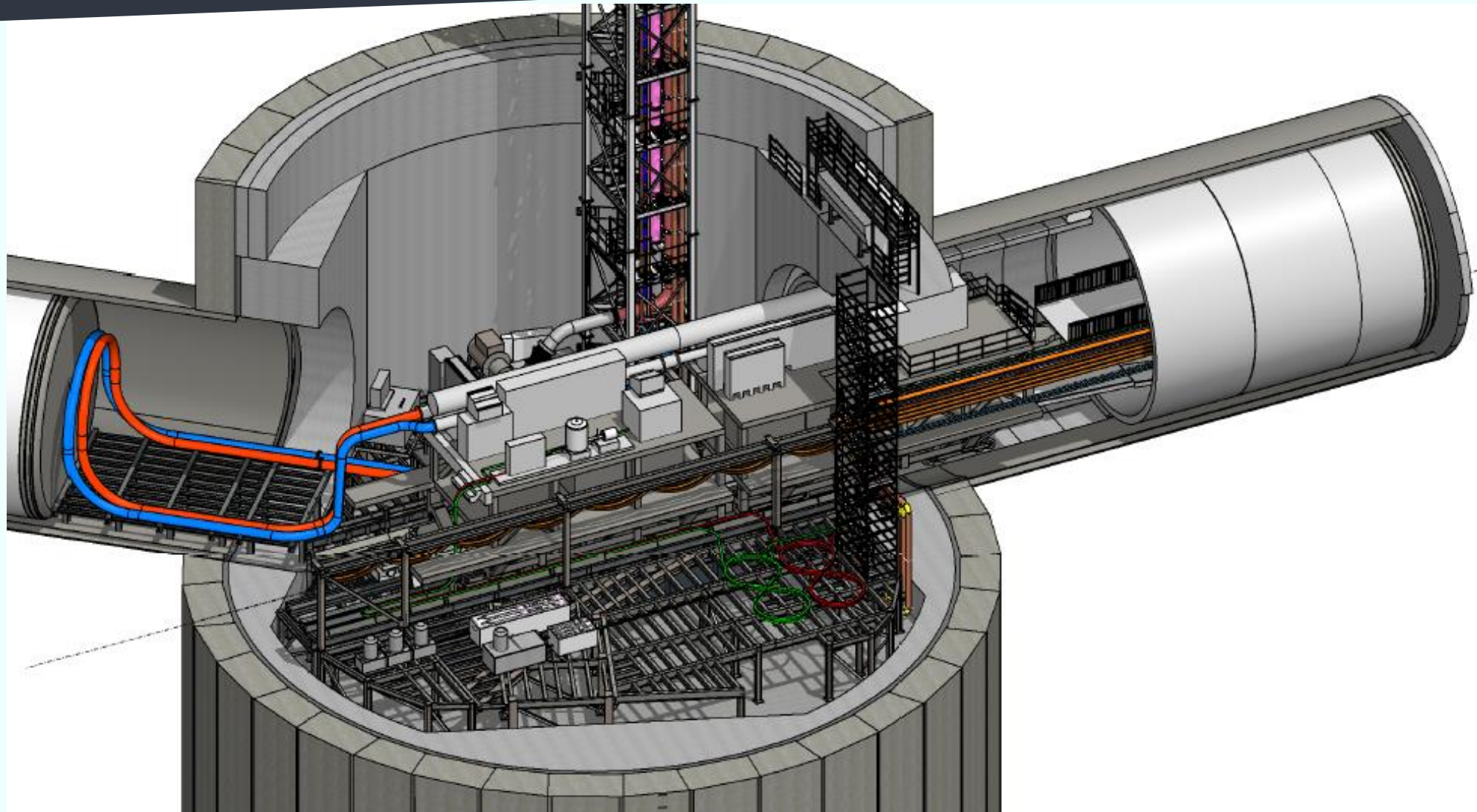



# TBM 'SELINA'

## Mining & Installation of Tunnel Rings

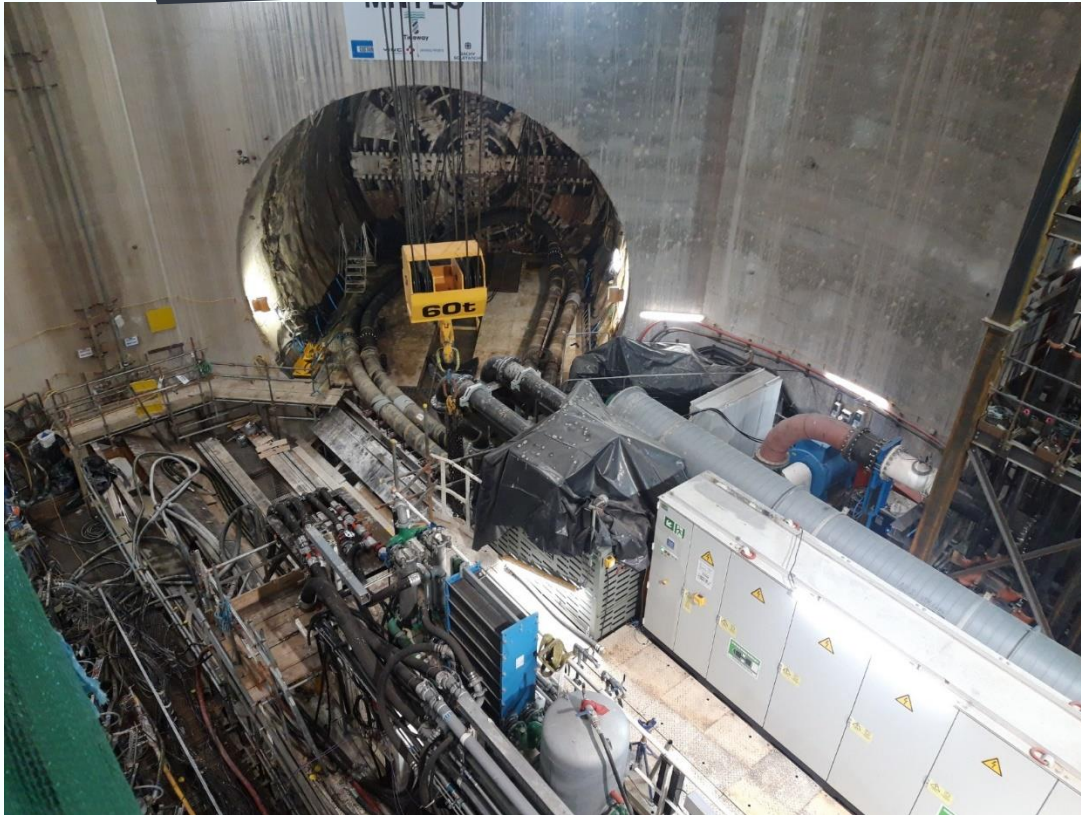

**22 January – Selina reached Ring 11**

**8 January – Selina declared Ready to Bore**





# TBM 'SELINA'

## Tunnel Rings





# TBM 'SELINA'

## Building the TBM & Installing Gantries



Tideway

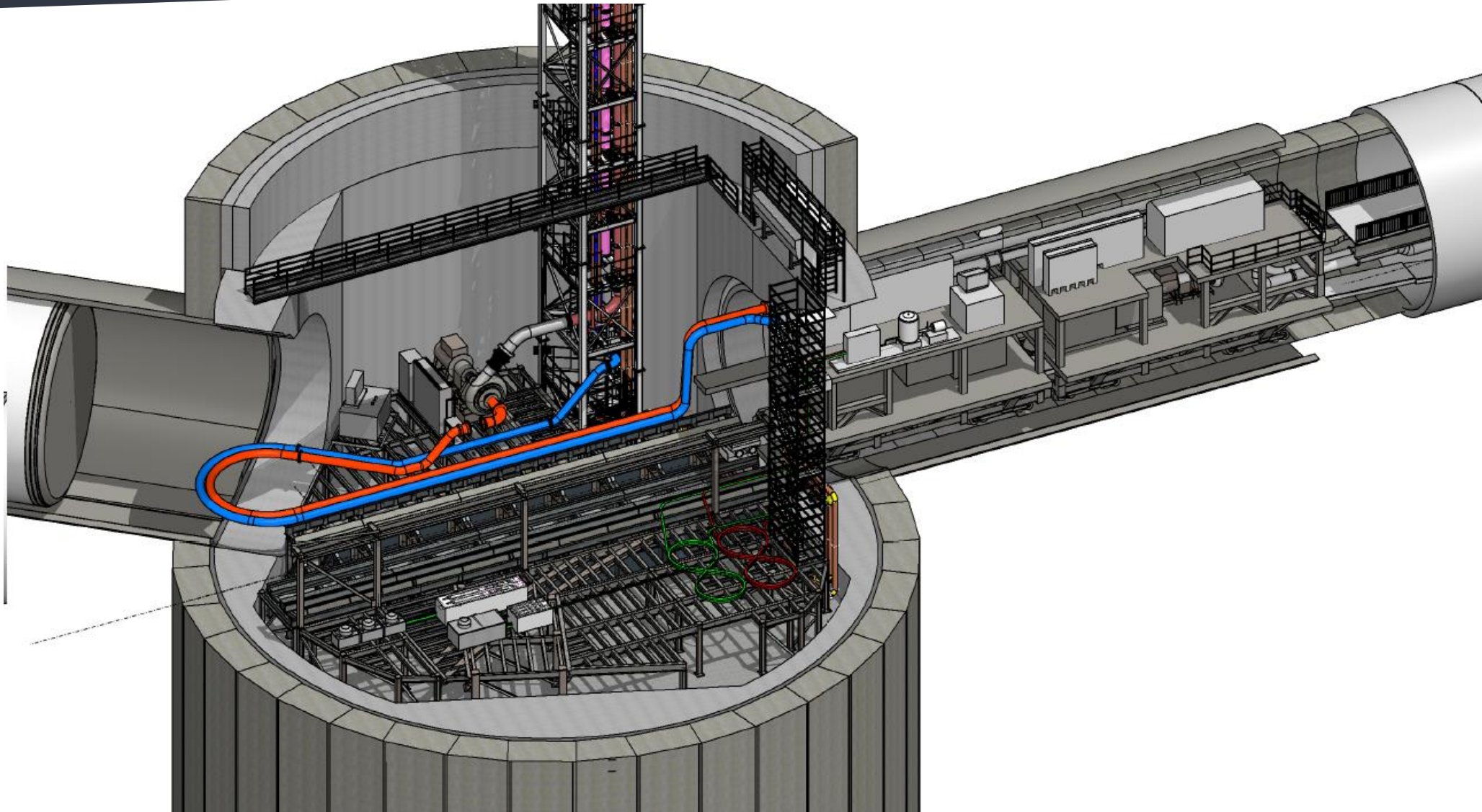



# TBM 'SELINA'





# TBM 'SELINA'

## Installation of Gantries



**6 Gantries in Total**

**Gantries 1 & 2: used to Launch TBM**

**Gantry 3: now installed, Gantry 4: soon**

**Gantry 5 & 6: due in mid-February**



# TBM 'SELINA'

## Mining, Tunnel Rings & Installation of Gantries

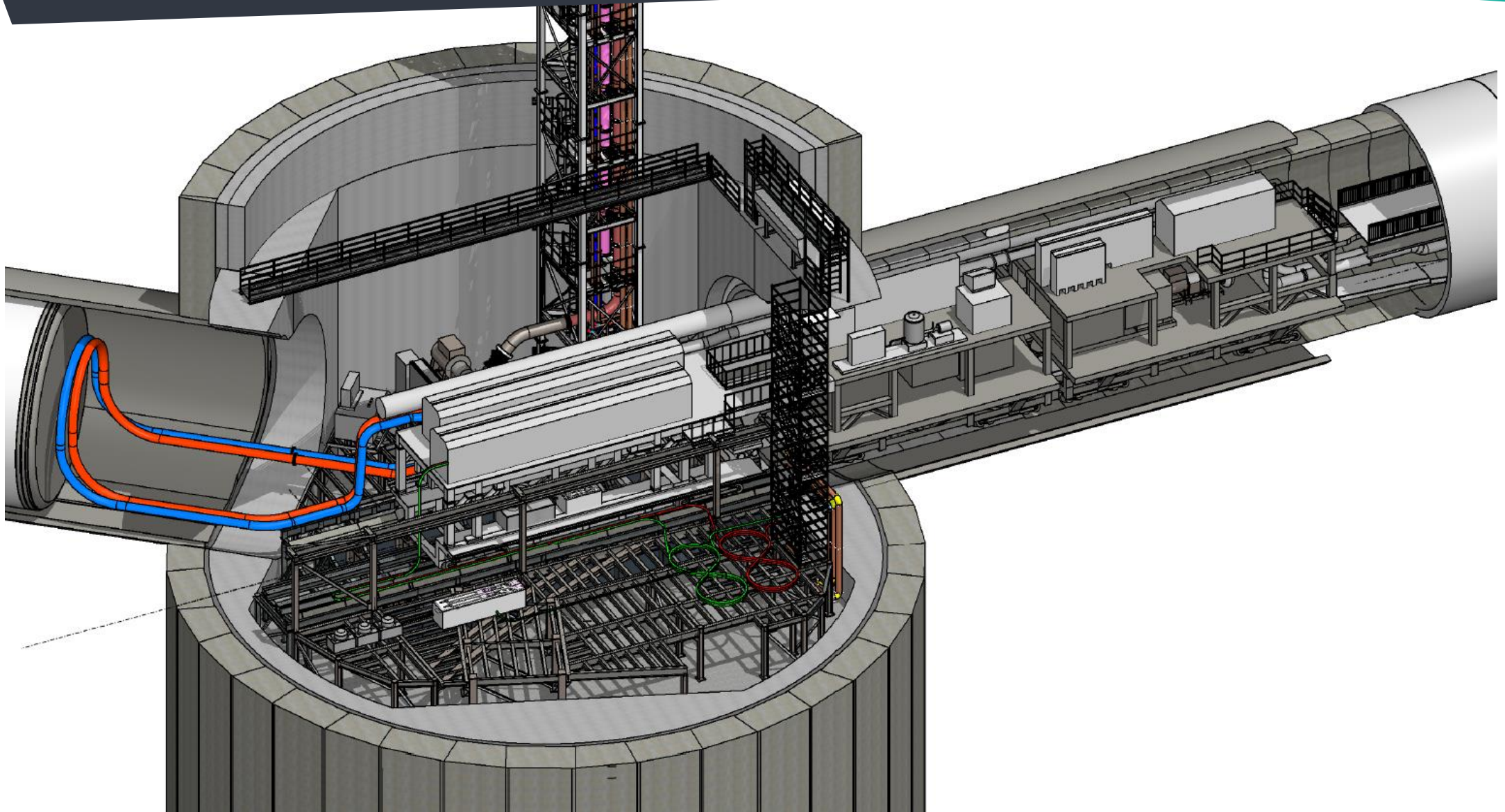



# SLURRY TREATMENT PLANT

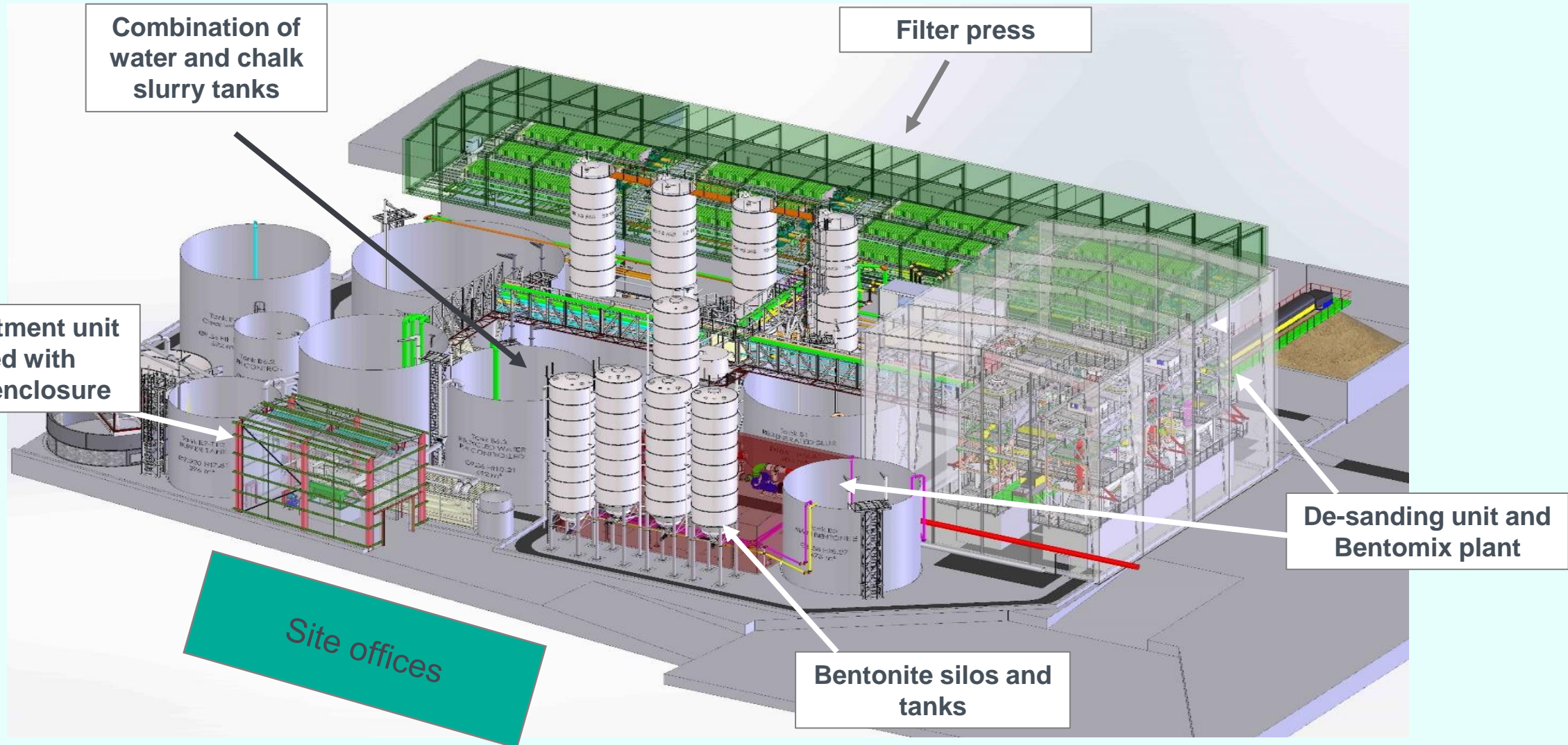



# SLURRY TREATMENT PLANT



December 2020 (left) to January 2021 (below) where the STP is now fully operational

What a difference after 1 month & Mining 10 Tunnel Rings!



The slurry has larger material removed by a Trommel, before the remaining slurry has water 'pressed out' and the resulting 'cake' is stock piled for removal by barge



# SLURRY TREATMENT PLANT





# REMOVAL OF TBM 'URSULA'





# WATER MAIN WORKS REPAIRS





# SECTION 61 - OVERVIEW

Section 61 phase five for tunnelling works – approved by LB Southwark for October 2019 to October 2020

## Permitted Site Working Hours

### Standard Working Hours:

- 08:00 to 18:00 (Monday to Friday) and 08:00 to 13:00 (Saturday)

### Extended Working Hours

- 18:00 to 22:00 (Monday to Friday). 08:00 to 17:00 (Saturday)
- General works limited to tidally influenced marine movements, lighting (task specific) and gantry crane movements within shaft enclosure

### Continuous Working Hours (24/7)

Tunnelling and tunnel related activities such as;

- Annulus infill
- Launch and reception adit construction
- STP operation
- Shaft set-up for tunnelling, TBM install and launch

### Mobilisation and demobilisation Hours •

- 07:00 to 08:00 and 18:00 to 19:00 (Monday to Friday).
- 07:00 to 08:00 and 13:00 to 14:00 (Saturday)
- 22:00 to 22:30 (Extended working hours activities) (Mon to Fri). 17:00 to 17:30 (Extended working on Saturdays)





# SECTION 61

Section 61 phase five for tunnelling works – approved by LB Southwark covers: October 2019 to October 2020



## Section 61/working time details for upcoming shaft internal and annulus works

### 1) Shaft internal concreting works

- Delivery of concrete wagons to site between 18:00 – 22:00hrs on one evening to facilitate internal pit-bottom platform creation. [estimate of ~3 deliveries per hour].

### 2) Annulus infill works

- Weekday delivery of concrete wagons between 18:00 – 20:00 [estimate of ~3 deliveries per hour].
- Weekday delivery of GGBS/ cement tankers on weekday evenings between 18:00 – 22:00 [estimate of ~2 deliveries per evening].
- Saturday delivery of concrete wagons between 13:00 – 18:00 [estimate of ~3 deliveries per hour].
- Saturday delivery of GGBS/ cement tankers between 18:00 – 22:00 [estimate of ~2 deliveries].
- Sunday delivery of GGBS/ cement and aggregate [estimate of 5 – 6 deliveries]
- Concrete wagons discharging within acoustic enclosure.
- All deliveries screened by existing acoustic buildings.



# Approved S61 for tunnelling works – more detail

- This Section 61 agreement covers:

## Tunnelling

- Tunnelling will be a continuous activity: 24 hours / 7 days a week, ongoing now
- The slurry treatment plant will also run continuously to support tunnelling activities



*An example of a tunnel adit being constructed*



*TBM 'Selina'*



# NOISE AND AIR QUALITY



Tideway





# AIR AND NOISE QUALITY MONITORING

## OCTOBER 2020

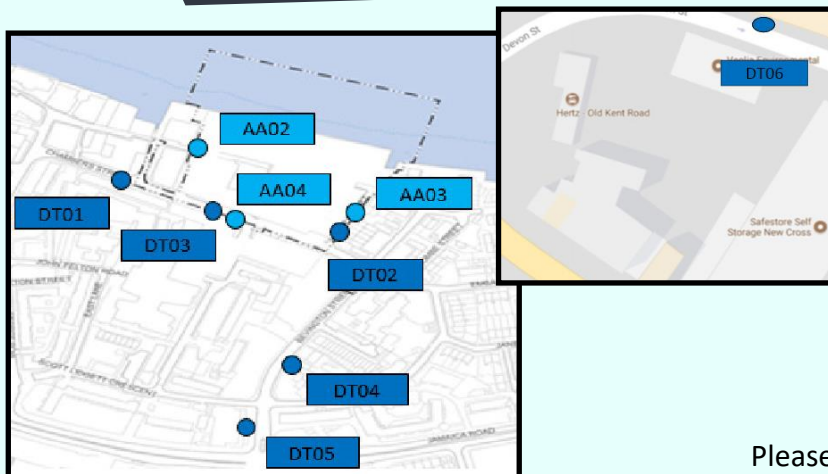

Please note that NO<sub>2</sub> pollutant concentration results are presented one month in arrears.

Location	UK Air Quality Objective	NO <sub>2</sub> µg/m <sup>3</sup>	Mean value for NO <sub>2</sub> µg/m <sup>3</sup>	Annual mean value for NO <sub>2</sub> µg/m <sup>3</sup> (with bias correction)
DT1	40	28.13	28.92	27.19
DT2		24.21	26.07	24.51
DT3		25.61	27.96	26.28
DT4		23.94	31.42	29.54
DT5		31.28	36.00	33.84
DT6		33.67	32.11	30.19
Monitoring period			Monitoring period	
02/09/2020	-	30/09/2020	02/10/2019	- 30/09/2020

Total Allowable Alerts	35 per year
Total May Alerts	0
Number of Alerts (12-month rolling)	6

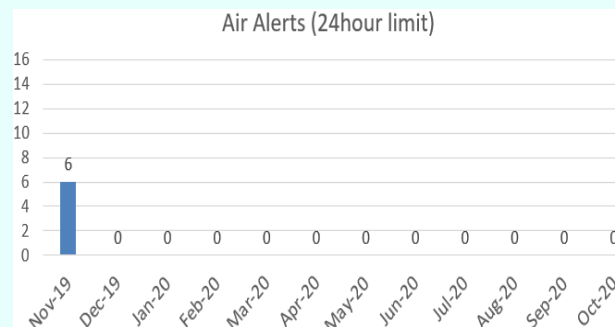

## Noise Monitoring October 2020

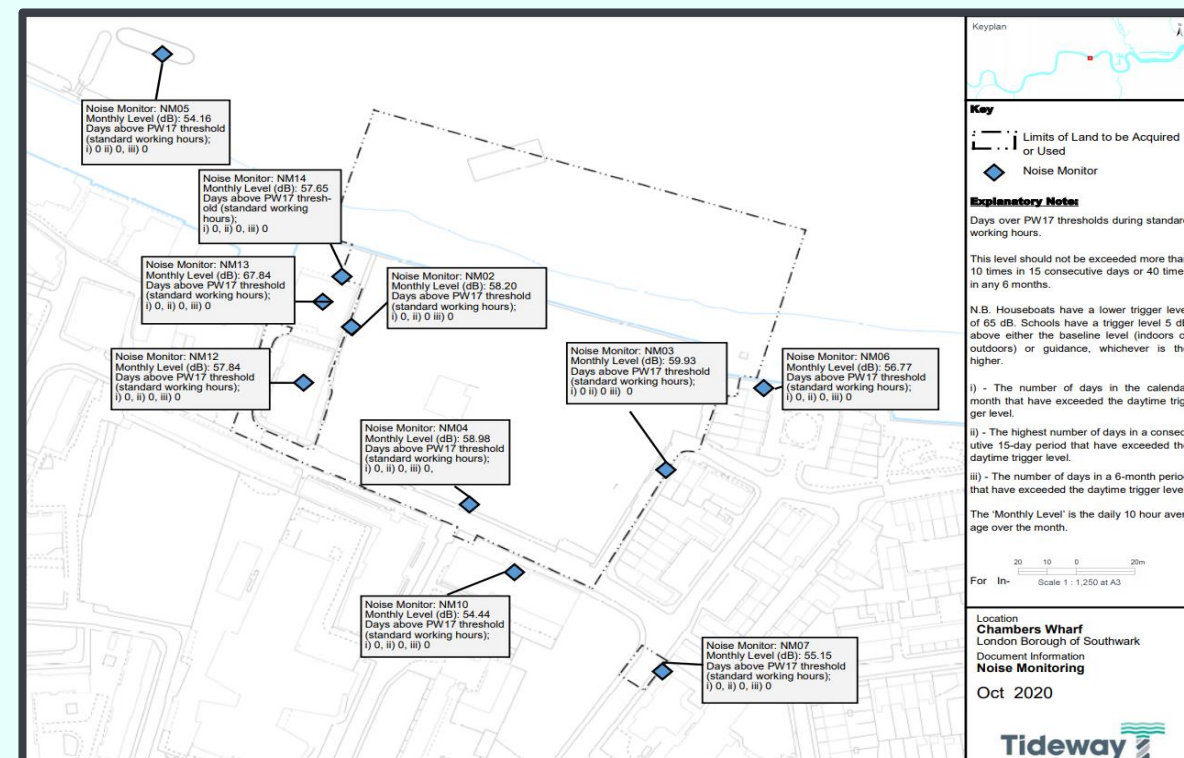



# AIR AND NOISE QUALITY MONITORING

## NOVEMBER 2020

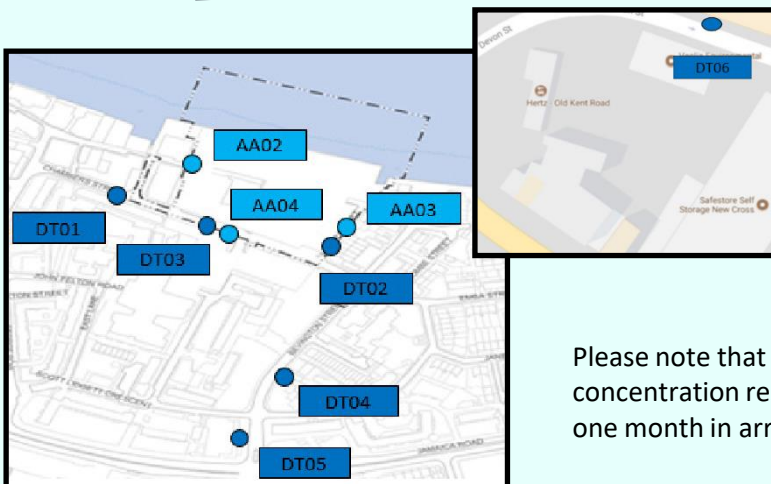

Please note that NO<sub>2</sub> pollutant concentration results are presented one month in arrears.

Location	UK Air Quality Objective	NO <sub>2</sub> µg/m <sup>3</sup>	Mean value for NO <sub>2</sub> µg/m <sup>3</sup>	Annual mean value for NO <sub>2</sub> µg/m <sup>3</sup> (with bias correction)
DT1	40	26.79	29.46	27.69
DT2		23.06	26.56	24.97
DT3		22.55	29.30	27.54
DT4		26.93	32.44	30.49
DT5		32.76	37.01	34.79
DT6		31.41	32.53	30.58
Monitoring period			Monitoring period	
30/09/2020	-	04/11/2020	08/11/2019	- 04/11/2020

Total Allowable Alerts	35 per year
Total May Alerts	0
Number of Alerts (12-month rolling)	0

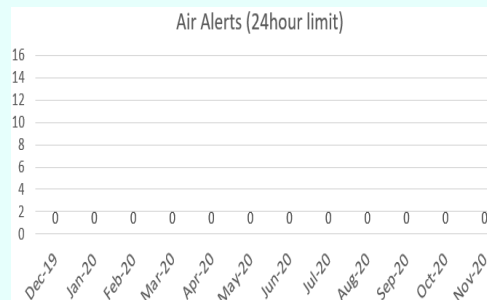

## Noise Monitoring November 2020

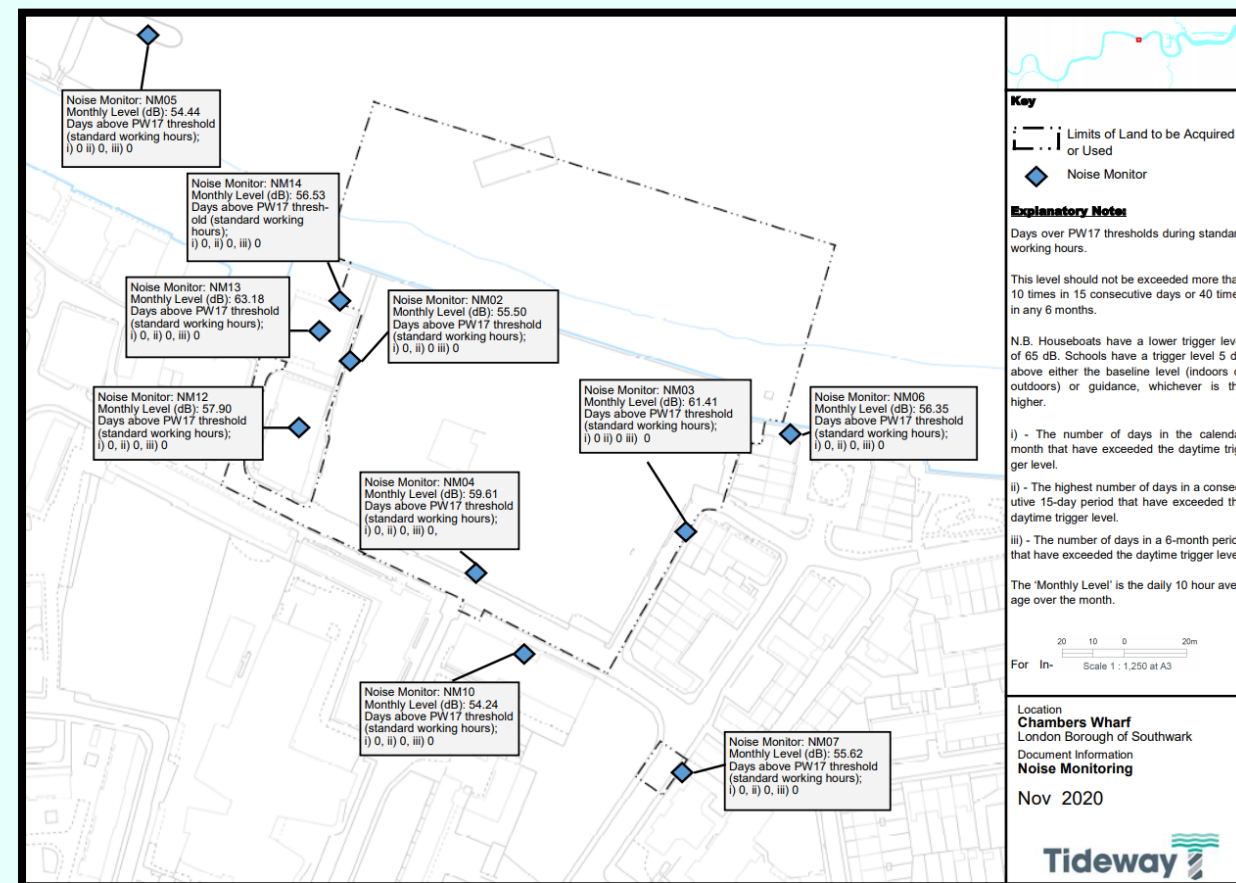



# AIR AND NOISE QUALITY MONITORING

## DECEMBER 2020

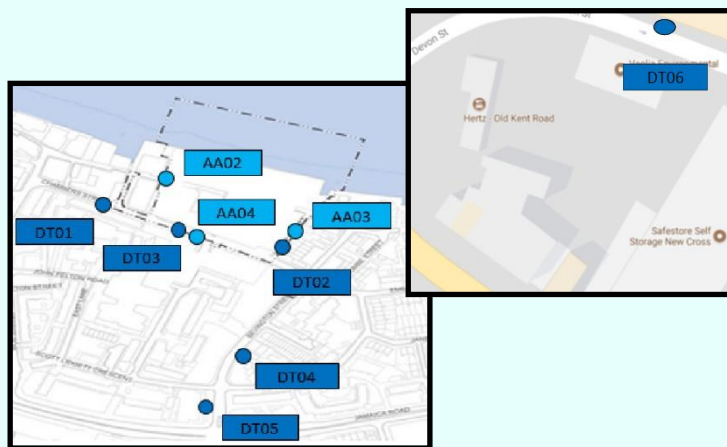

Location	UK Air Quality Objective	NO <sub>2</sub> µg/m <sup>3</sup>	Mean value for NO <sub>2</sub> µg/m <sup>3</sup>	Annual mean value for NO <sub>2</sub> µg/m <sup>3</sup> (with bias correction)
DT1	40	37.51	30.52	28.68
DT2		32.68	27.49	25.84
DT3		31.12	27.72	26.05
DT4		34.27	34.17	32.12
DT5		41.89	37.79	35.52
DT6		43.12	33.17	31.18
Monitoring period			Monitoring period	
04/11/2020	-	02/12/2020	04/12/2019	- 02/12/2020

Please note that NO<sub>2</sub> pollutant concentration results are presented one month in arrears.

Total Allowable Alerts	35 per year
Total May Alerts	0
Number of Alerts (12-month rolling)	0

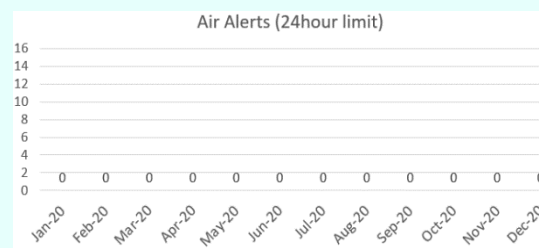

## Noise Monitoring December 2020

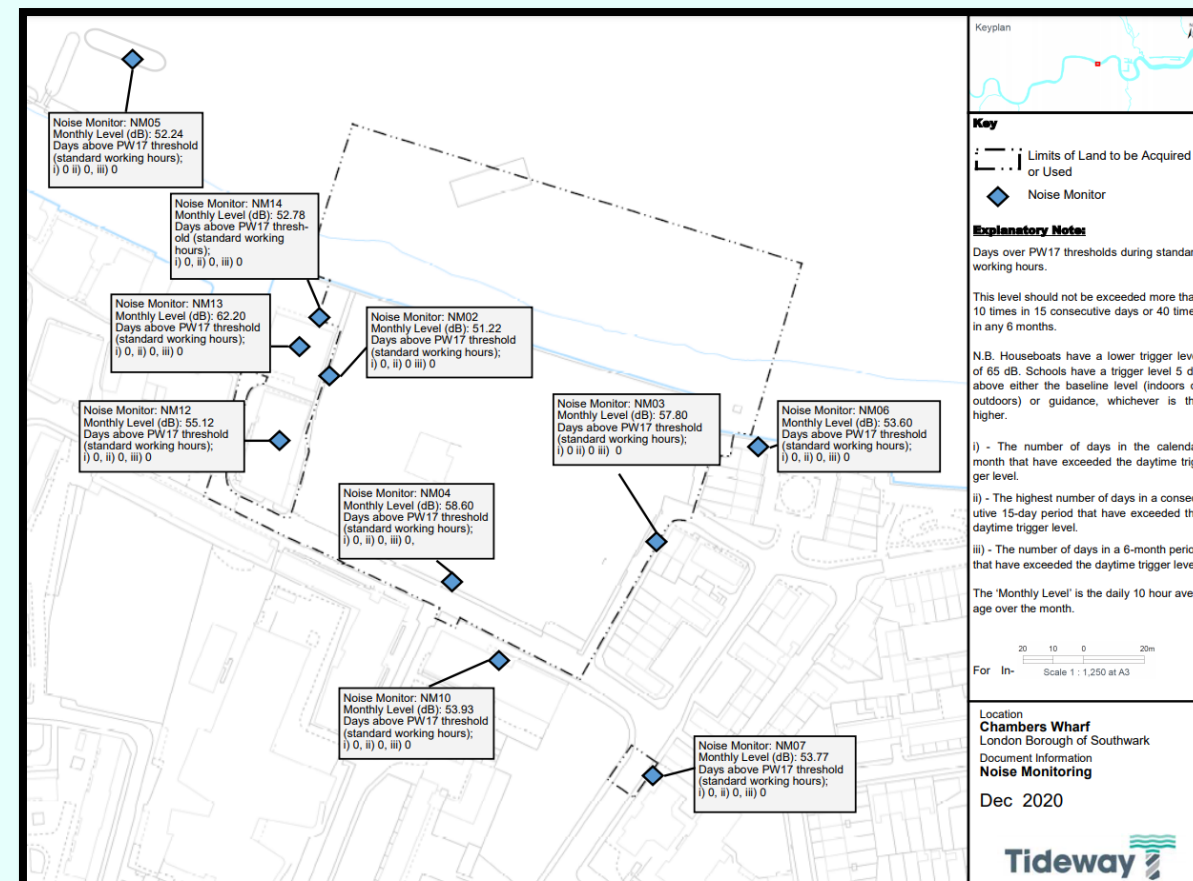



# LEGACY



Tideway





# LEGACY

COMMUNITY INVESTMENT



Tideway

## KICKSTART SCHEME



100% Government Funded Work Placement for 16 – 24 Yr Olds

### Kickstart Scheme

To support young people impacted by COVID 19 pandemic, who are at risk of being left behind in the jobs market, offering 6 month placements.

See more below :

[Want a Kickstart? - Job help \(campaign.gov.uk\)](https://www.campaign.gov.uk)

## Creekside Centre Deptford Creek



## LOOG

Local Opportunities and Outreach Group



Meeting in Feb 2021, with external partners, to ensure a suitable workforce to deliver the works, promote opportunities for local people, disadvantaged groups and local businesses and support initiatives to promote STEM education and careers.

**Southwark – Greenwich – Tower Hamlets –  
Lewisham - Newham**



# MITIGATION



Tideway





## How To Make A Claim if Affected By Tideway's Work

### Who do I go to for advice?

Independent Advisory Service (IAS) Helpline for independent advice:

- 0800 917 8845 or [info@tidewayias.co.uk](mailto:info@tidewayias.co.uk)
- Tideway's Compensation Lead, Louise Walsh, for personal assistance and advice
  - Helpdesk: 08000 30 80 80 / [helpdesk@tideway.london](mailto:helpdesk@tideway.london) or
  - Direct: 07971 077165 / [louise.walsh@tideway.london](mailto:louise.walsh@tideway.london)

### How do I submit my claim?

Louise can submit your claim to the Independent Compensation Panel (ICP) on your behalf, or you can submit your claim direct to the ICP: [admin@tidewayicp.london](mailto:admin@tidewayicp.london)

The IAS can send you a claim form, or you can download the form off the Tideway website: [www.tideway.london/help-advice/compensation-information/Independent-Compensation-Panel](http://www.tideway.london/help-advice/compensation-information/Independent-Compensation-Panel)



# THANK YOU



# Any Questions





## Contact US

If you do have any questions or enquiries, please contact the Tideway Helpdesk:

Telephone: **0800 030 80 80**

Email: **[Helpdesk@Tideway.London](mailto:Helpdesk@Tideway.London)**





**Tideway**

# **RECONNECTING LONDON WITH THE RIVER THAMES**

**#SuperSewer**

[www.tideway.london](http://www.tideway.london)