

INFORMATION SHEET

January 2023



Tideway



Balfour Beatty

KING GEORGE'S PARK FOOTPATH CLOSURE

Work at our King George's Park site is progressing well as we continue with the final stages of our landscaping activities.

To enable us to safely deliver and install the large granite stones at the park entrance on site, for one week from 18:00 Sunday 15 January we will closing the footpath and also one lane of the existing carriageway that runs adjacent to our site on Buckhold Road.

A temporary pedestrian crossing will be installed within the temporary traffic lights to maintain access along Buckhold Road. The temporary traffic light system will be put in place to control the single lane traffic on this part of the road network. Please see the diagram on the right.

We apologise in advance for any inconvenience this may cause you and encourage anyone who has any queries or concerns regarding our works on our King George's Park site to please contact the Tideway Helpdesk on 0800 030 8080 or at helpdesk@tideway.london

If you feel affected by Tideway's work, you can contact Tideway's Helpdesk and they will be able to advise you on the Independent Compensation Panel (ICP).

Tideway is happy to provide information in other languages and formats such as braille or large print. Please contact us: 08000 30 80 80 or helpdesk@tideway.london.

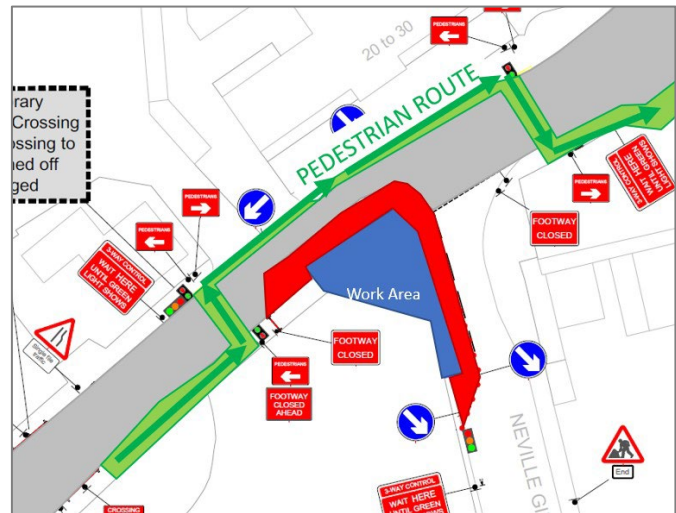

KEY INFO

Duration of work

- 1 week : 15 January to 22 January

What to expect

- Closure of footpath and one lane of the existing carriageway

- Installation of temporary traffic light and pedestrian crossing to manage the single lane traffic and diversion route for pedestrians

What will we do

- Place directional signage for pedestrians
- Contact you if our plans change

24 HOUR HELPDESK 08000 30 80 80

helpdesk@tideway.london | Freepost TIDEWAY

www.tideway.london



@TidewayLondon